



www.gillathletics.com
800-637-3090

PIT GARAGE ASSEMBLY LOCATION AND TRANSPORTATION REQUIREMENTS

BUILD AREA

A MINIMUM AREA OF 35'x35'
IS RECOMMENDED TO ASSEMBLE
EACH PIT GARAGE.

THIS AREA NEEDS TO BE AS FLAT
AS POSSIBLE.

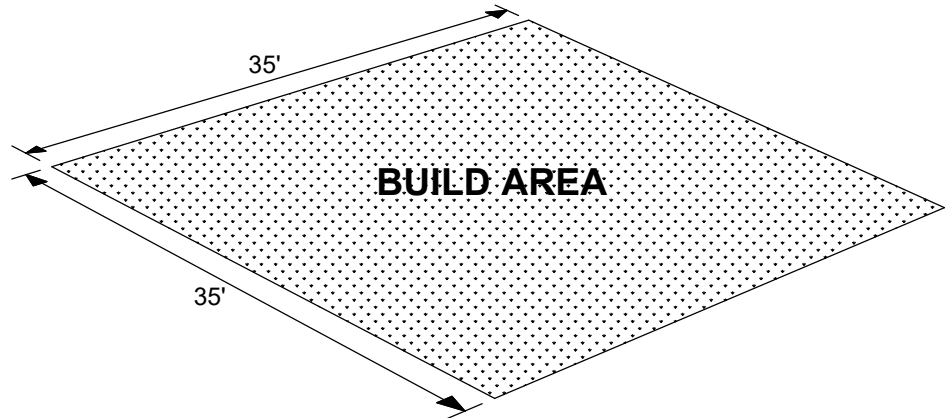

MOVING THE GARAGE

MAKE SURE THAT THE PIT GARAGE
CAN BE MANEUVERED FROM THE
BUILD LOCATION TO THE LANDING
AREA WITH MINIMAL OBSTACLES
BLOCKING THE PATH.

IF GARAGE IS ASSEMBLED AWAY
FROM THE LANDING AREA, A 30'
WIDE PATH NEEDS TO BE AS
FLAT AS POSSIBLE WITHOUT ANY
OBSTACLES SUCH AS TREES,
FENCES OR DIPS IN TERRAIN.



A SLIGHT SLOPE IS PERMISSIBLE
IF CONSISTENT AND DOES NOT
DIP OR RISE TOO EXTREME
PREVENTING THE WHEELS AND
GARAGE UNDERSIDE TO GET
STUCK.

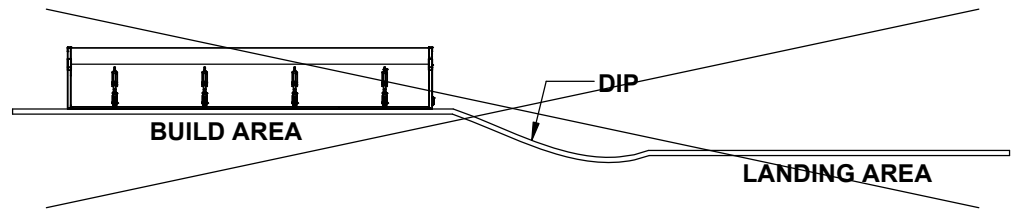

IF GROUND CONDITIONS ARE NOT
SUITABLE, THE PIT GARAGE MIGHT
NOT BE USABLE

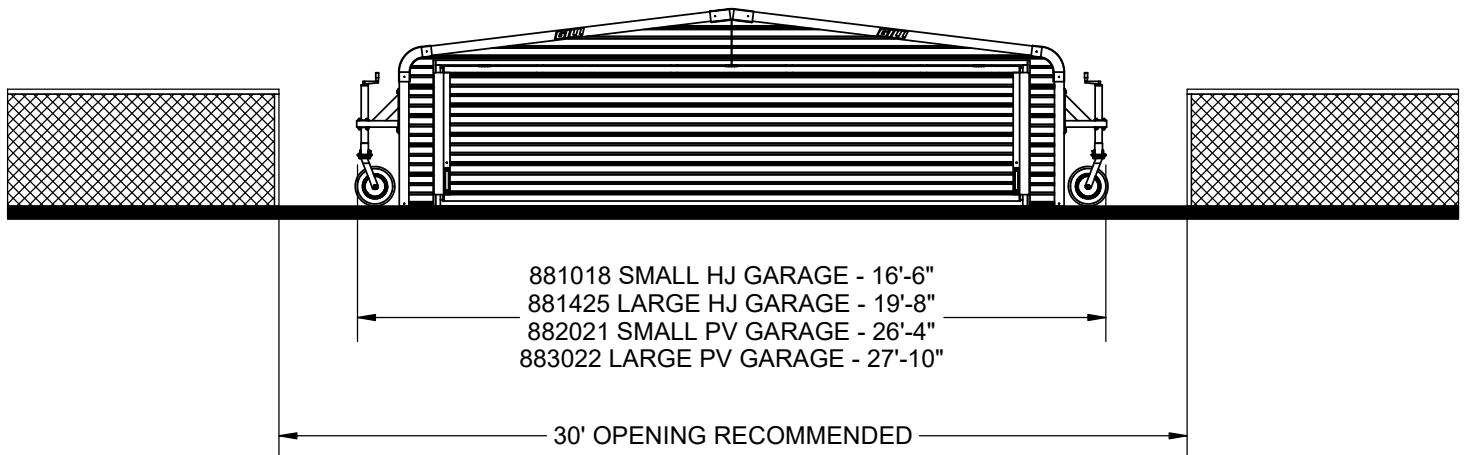

PIT GARAGE INSTALLATION INSTRUCTIONS

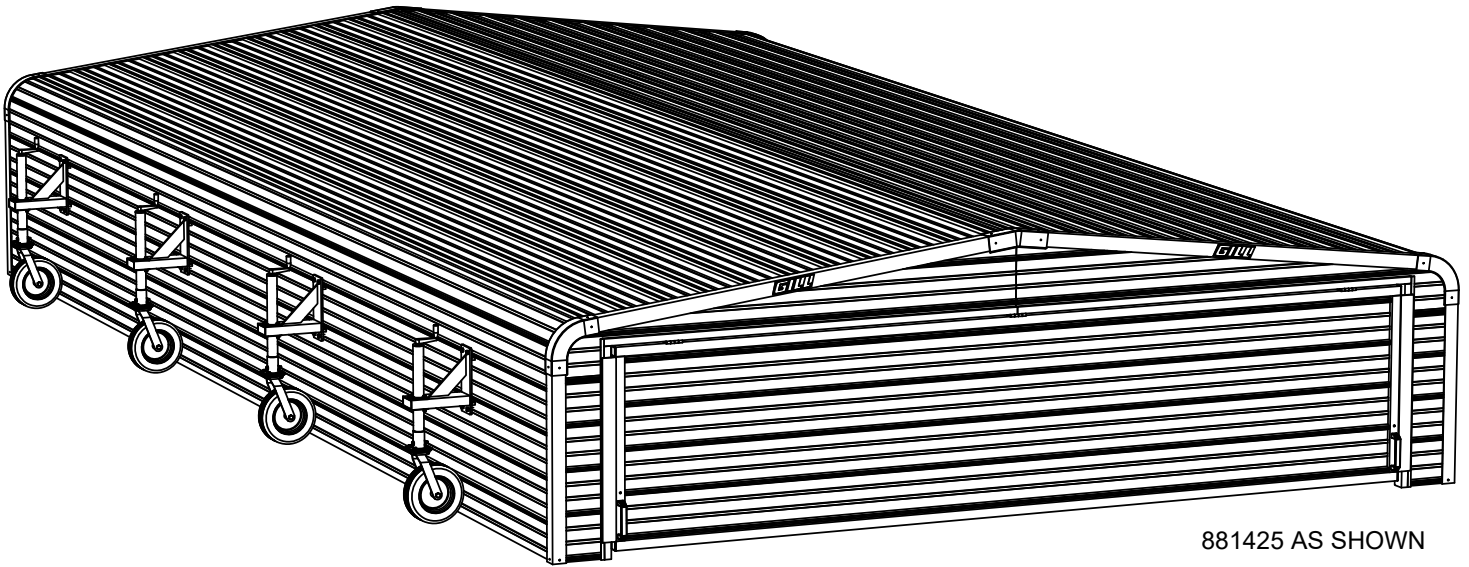

881425 AS SHOWN

TOOLS RECOMMENDED FOR ASSEMBLING A PIT GARAGE:

- STEP DRILL BIT OR DRILL BIT SET
- CAULKING GUN
- BOLT CUTTERS
- PHILLIPS HEAD SCREW DRIVER
- DRILL
- IMPACT DRIVER
- 5/16" DRIVER OR SOCKET (TEK SCREWS)
- 7/16" DRIVER OR SOCKET (FRONT AND REAR GUSSETS)
- 1/2" DRIVER OR SOCKET (GUSSETS TO UPRIGHTS)
- 3/4" DRIVER OR SOCKET (TRUSSES)
- 1/2" WRENCHES (2X)
- 3/4" WRENCHES (2X)
- RUBBER Mallet
- ELECTRIC CUTTERS (SIDING)
- STEP STOOL
- GLOVES AND EYE PROTECTION

BEFORE ASSEMBLY, READ ALL INSTRUCTIONS AND CHECK PARTS LIST AT BACK OF THESE INSTRUCTIONS TO ENSURE ALL COMPONENTS ARE ON SITE. LAYOUT ALL PARTS AND PLAN THE BUILD OF THE GARAGE IN A FLAT AREA.

1. ASSEMBLE THE LEFT AND RIGHT BOTTOM TUBE SPLICE WELDMENTS USING ONE 12" SPLICE AND TWO 1" SELF DRILLING SCREW (SEE DETAIL C).
2. ASSEMBLE THE REAR HORIZONTAL SPREADERS THE SAME WAY (ONE SPLICE AND TWO SELF DRILLING SCREWS).

NOTE: PIT GARAGE 881018 HAS ONE SINGLE REAR HORIZONTAL SPREADER. NO SPLICE NECESSARY. DIFFERENT SIZE GARAGES HAVE MORE OR LESS BOTTOM TUBE SPLICE WELDMENTS. ALL OF THEM GET ASSEMBLED THE SAME WAY.

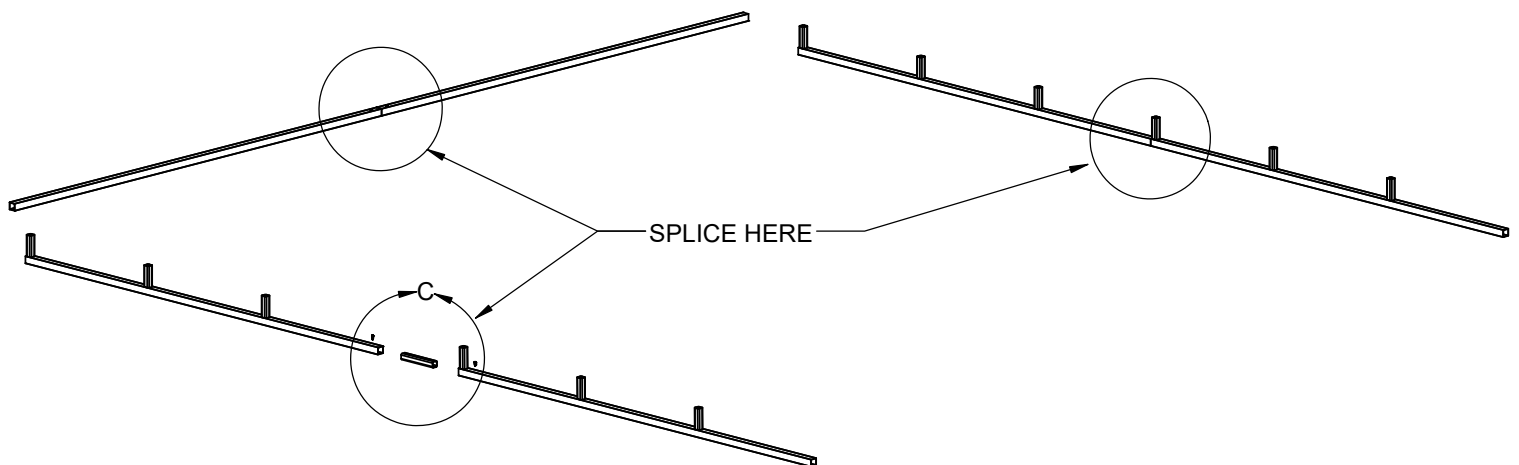

DETAIL C
 BOTTOM TUBE SPLICE

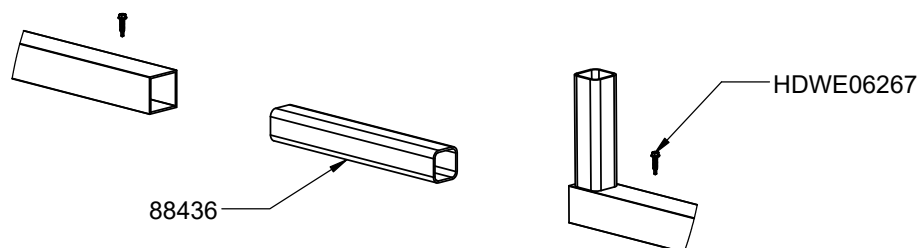

3. SLIDE DRILLED UPRIGHT ONTO 6" WELDED STUBS. SECURE EACH UPRIGHT WITH ONE SELF DRILLING SCREW.
4. ATTACH LEFT AND RIGHT FRONT CORNERS BY SLIDING THEM INSIDE OF THE BOTTOM SPLICE TUBES. ADD ONE SCREW TO LOCK IT IN PLACE.

NOTE: DO NOT PUT SCREWS ON OUTSIDE FACES. STEEL SIDING WILL NOT LAY FLAT AGAINST THE FRAMES IF SCREWHEADS ARE PRESENT ON OUTSIDE FACES.

NOTE: BE SURE UPRIGHT HOLES ARE ON TOP AND ALIGN TO EACH OTHER

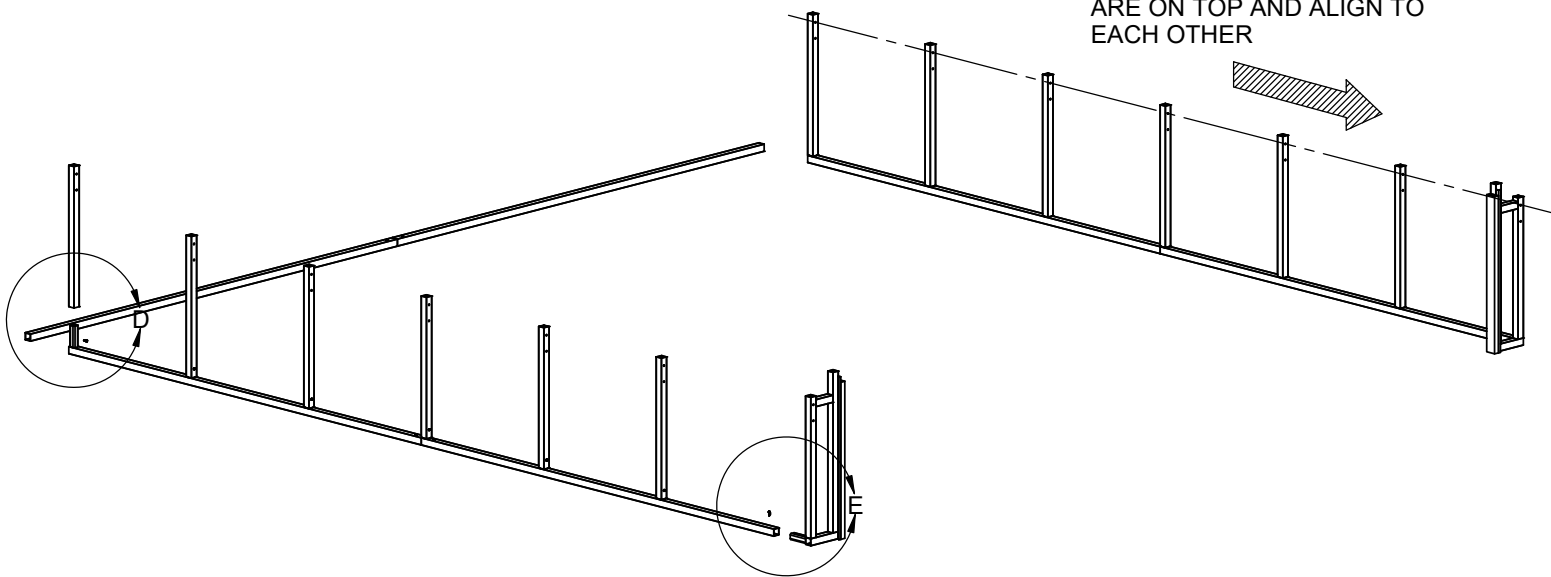

DETAIL D
 UPRIGHT SPLICE

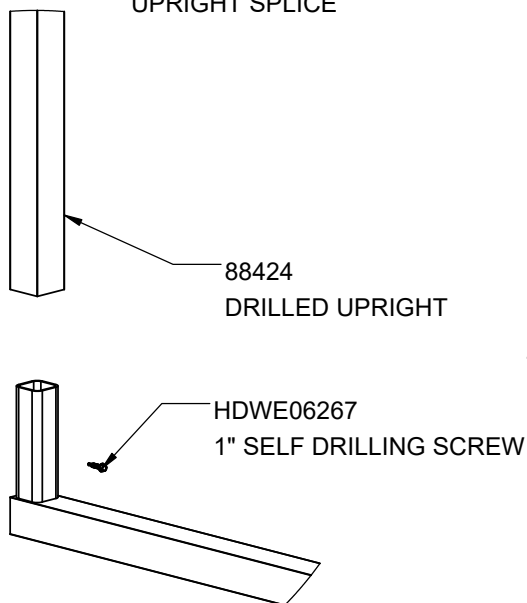

DETAIL E
 LEFT FRONT CORNER ATTACHMENT

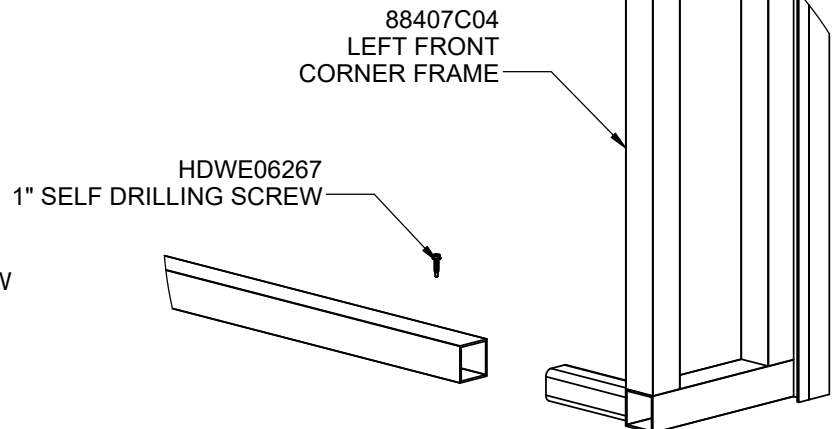

5. STARTING AT THE FRONT CORNER FRAMES, ADD DIAGONAL FLAT BRACES AND SECURE THEM USING 2" SELF DRILLING SCREWS. FIRST BRACE AT FRONT SHOULD START AT HIGH POSITION.

NOTE: ADDING THESE DIAGONAL BRACES MIGHT BE EASIER IF THE FRAME IS LAID FLAT ON THE GROUND. MAKE SURE THE BRACES ARE ATTACHED TO THE INSIDE OF THE FRAME.

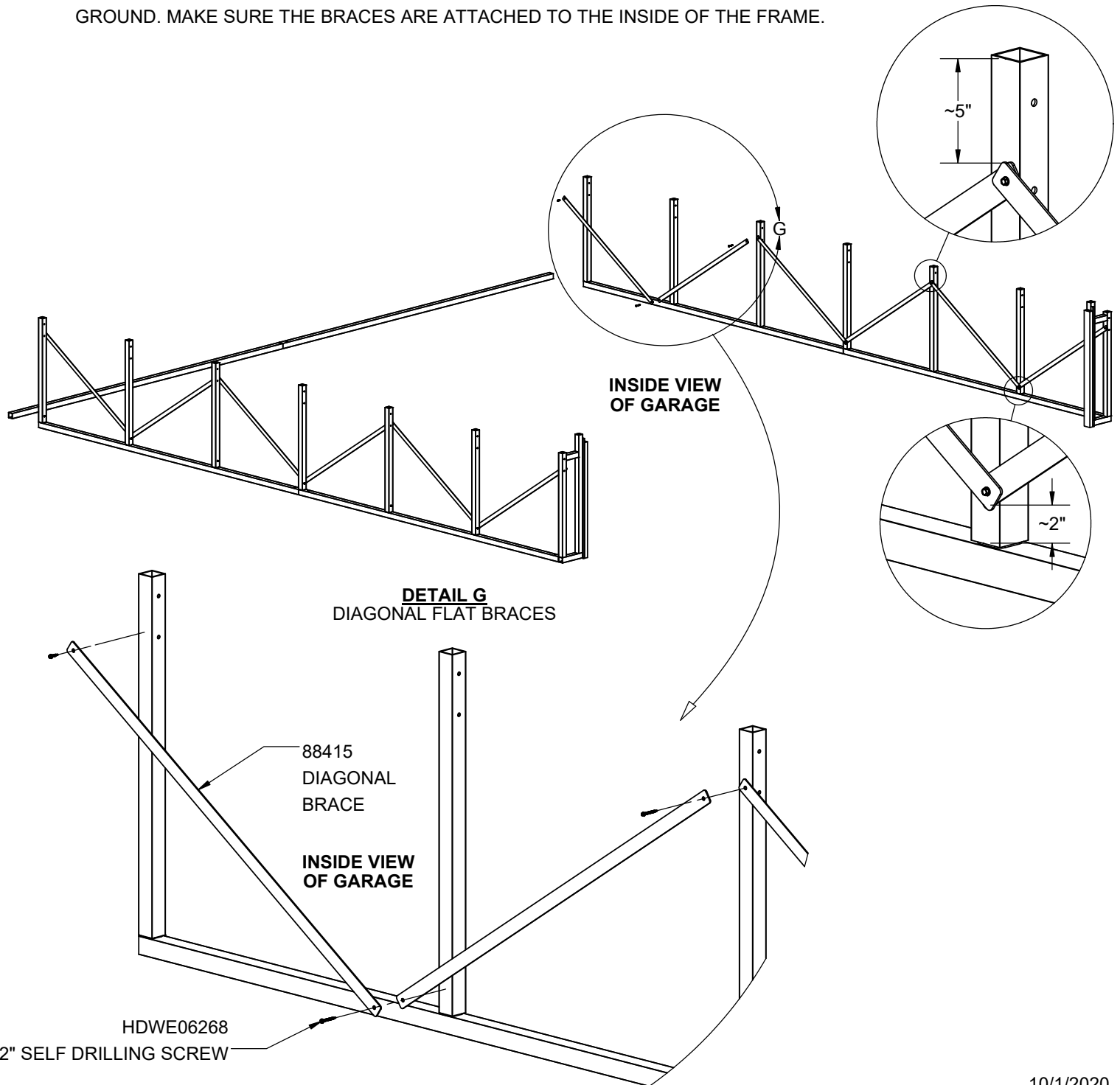

6. ATTACH TWO GUSSETS TO EACH CORNER UPRIGHT USING TWO FLAT HEAD SCREWS, FOUR FLAT WASHERS AND TWO 1/4" NYLOCK HEX NUTS.

NOTE: BE SURE THAT THE HEAD OF THE SCREW FACES THE OUTSIDE OF THE GARAGE. THIS WILL KEEP THE SIDING FLAT TO THE STRUCTURE.

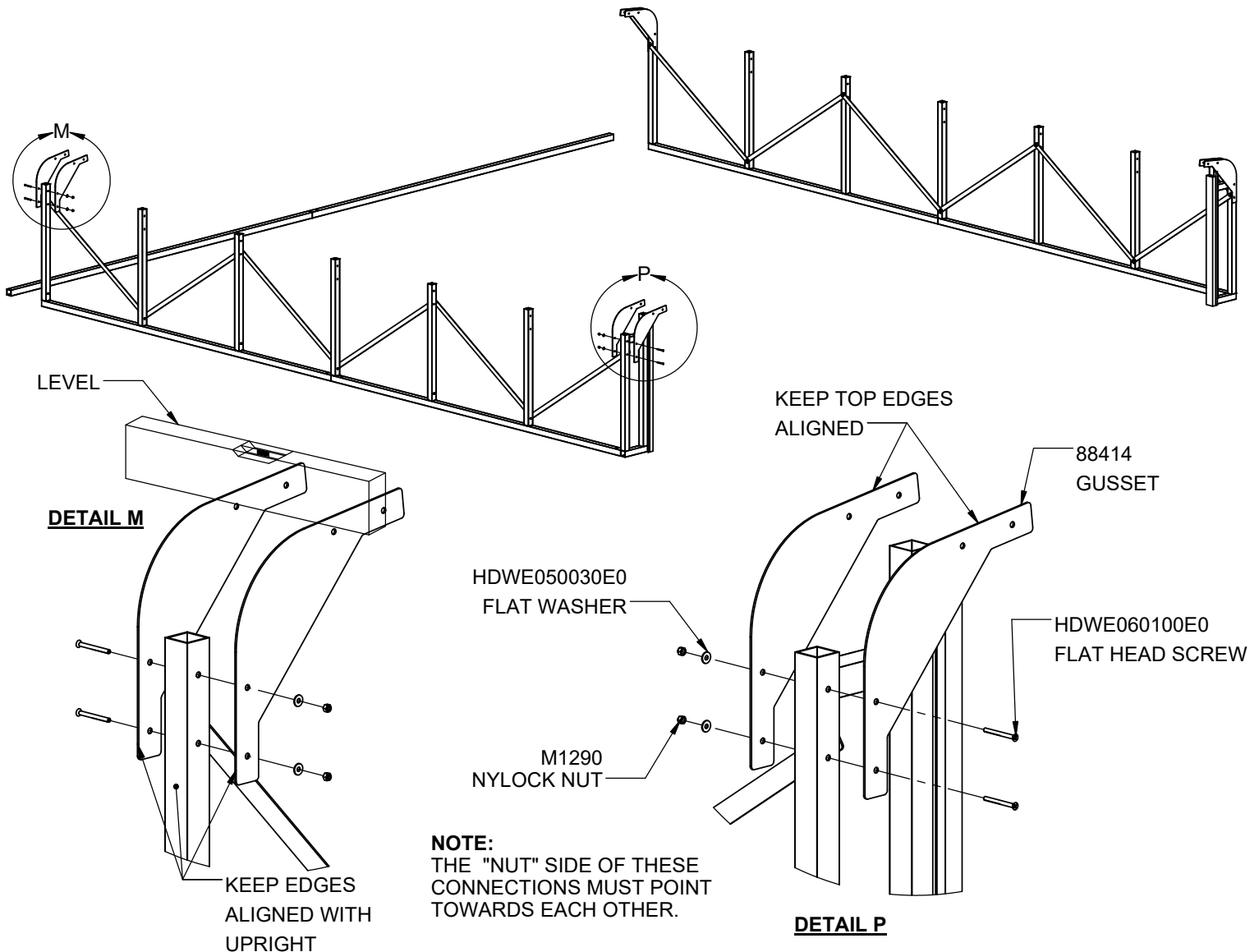

7. ATTACH TWO GUSSETS TO EACH INSIDE UPRIGHT USING TWO 5/16" HEX BOLTS, FOUR 5/16" FLAT WASHERS AND TWO 5/16" NYLOCK HEX NUTS.

NOTE: ALIGN ALL GUSSET TOP FACES TO EACH OTHER. ALSO, ALIGN GUSSETS WITH UPRIGHT BACK FACES. THIS WILL KEEP THE SIDING FLAT TO THE STRUCTURE (REFER TO **DETAIL BH** & **DETAIL T**).

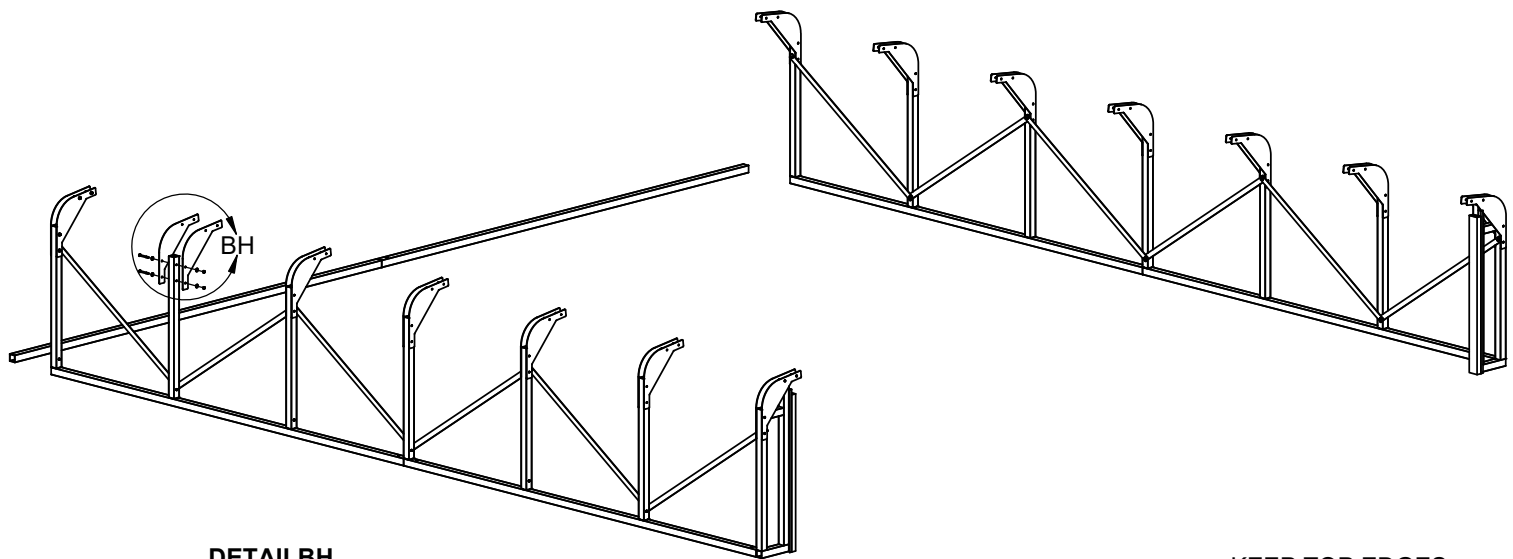

DETAIL BH
 INSIDE GUSSETS

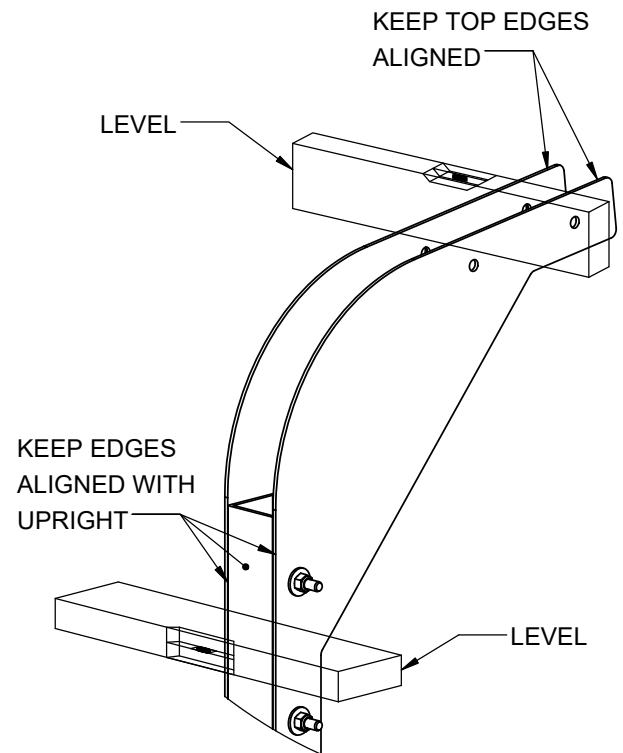
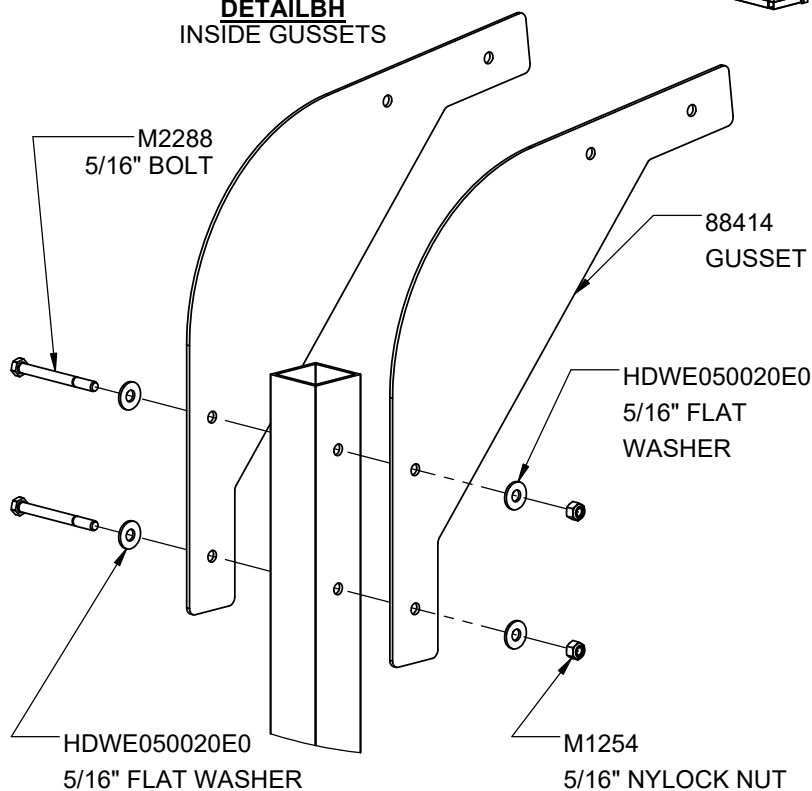

DETAIL T

8. ASSEMBLE ALL HALF TRUSSES USING 1/2"-13 X5" BOLTS, FLAT WASHERS AND NYLOCK HEX NUTS.
9. ASSEMBLE THE TWO FRONT TRUSSES (LEFT AND RIGHT) THE SAME WAY.

NOTE: DIFFERENT SIZE GARAGES HAVE DIFFERENT SIZED TRUSSES. ALL OF THEM GET ASSEMBLED THE SAME WAY.

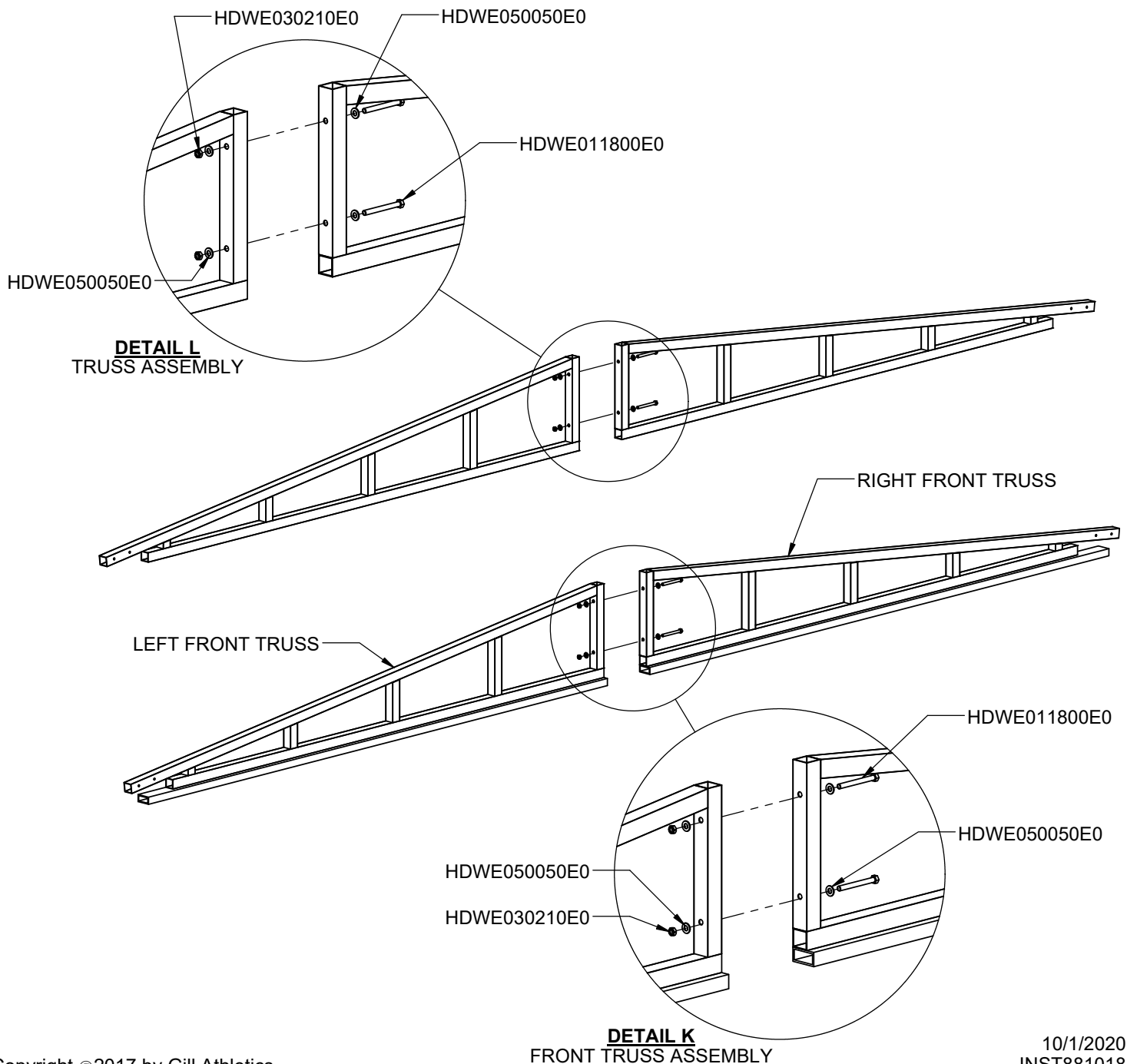

10. SLIDE REAR HORIZONTAL SPREADER OR SPREADER ASSEMBLY IN PLACE.
11. FASTEN TO BACK UPRIGHTS USING ONE CORNER BRACKET AND FOUR 1" SELF DRILLING SCREWS.

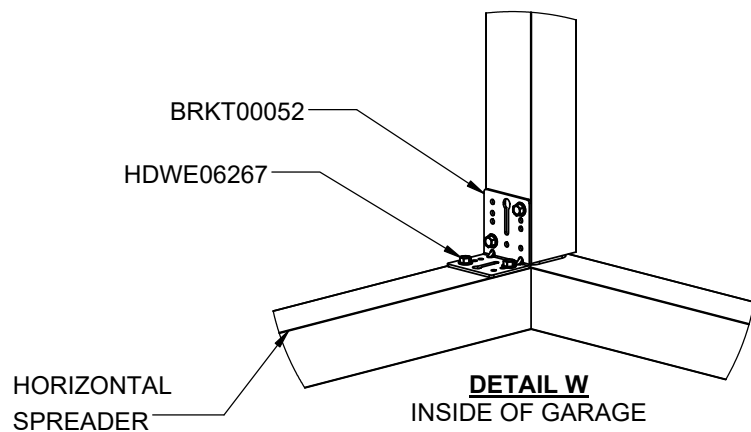
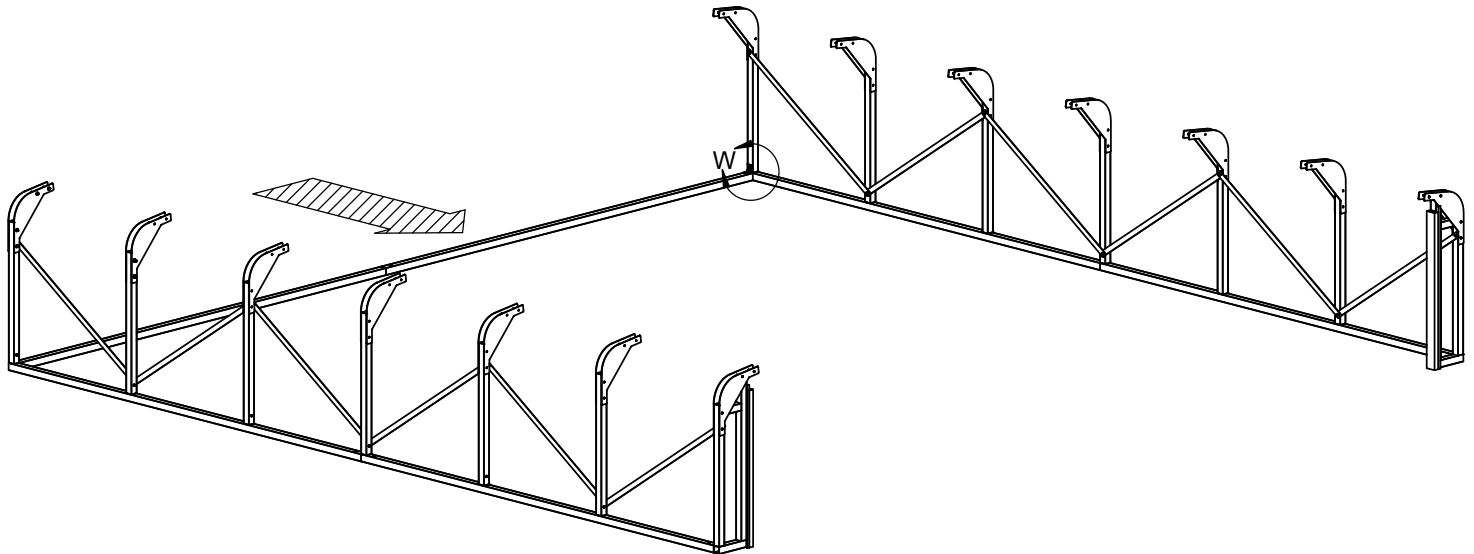

14. LAYOUT REAR VERTICAL SPREADERS AS SHOWN IN THE DIAGRAMS BELOW PER YOUR GARAGE. USE TWO CORNER BRACKETS AND EIGHT 1" SELF DRILLING SCREWS PER SPREADER. INSTALL ONE BRACKET AT THE HORIZONTAL SPREADER AND ONE AT THE TRUSS.

NOTE: DO NOT PUT SCREWS ON OUTSIDE FACES. STEEL SIDING WILL NOT LAY FLAT AGAINST THE FRAMES IF SCREWHEADS ARE PRESENT ON OUTSIDE FACES.

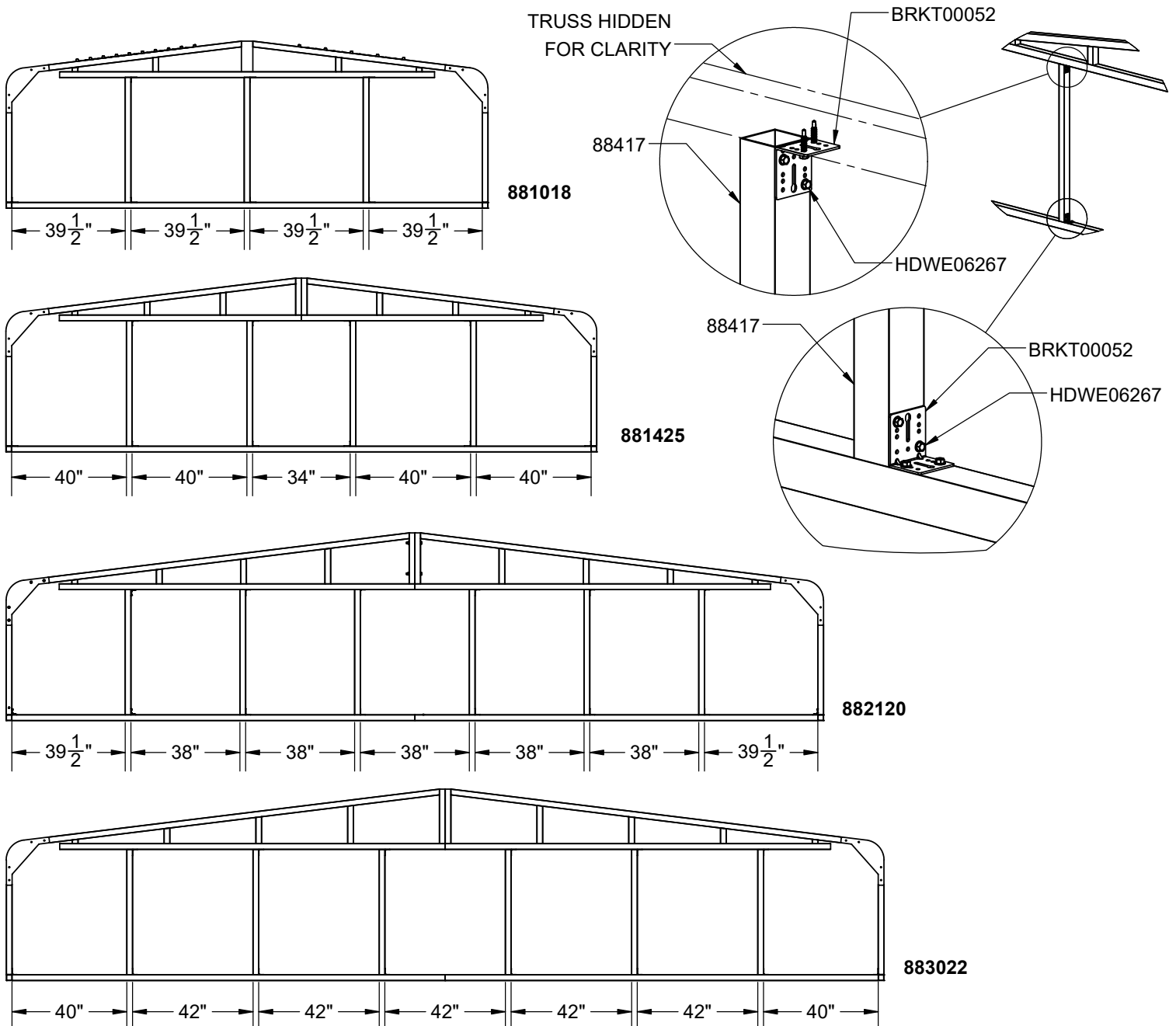

AT LEAST TWO PEOPLE ARE REQUIRED WHEN ADDING ALL TRUSS ASSEMBLIES.

NOTE: HAVE THE HARDWARE READY BEFORE PUTTING THE ASSEMBLED TRUSSES IN PLACE.

12. LOWER REAR TRUSS ASSEMBLY IN PLACE. FASTEN THE TRUSS USING TWO 1/4" FLAT HEAD SCREWS, FOUR 1/4" FLAT WASHERS AND TWO 1/4" NYLOCK HEX NUTS.
13. LOWER FRONT TRUSS ASSEMBLY IN PLACE. FASTEN THE TRUSS USING TWO 1/4" FLAT HEAD SCREWS, FOUR 1/4" FLAT WASHERS AND TWO 1/4" NYLOCK HEX NUTS.

THE STRUCTURE IS NOW ABLE TO STAND ON ITS OWN.

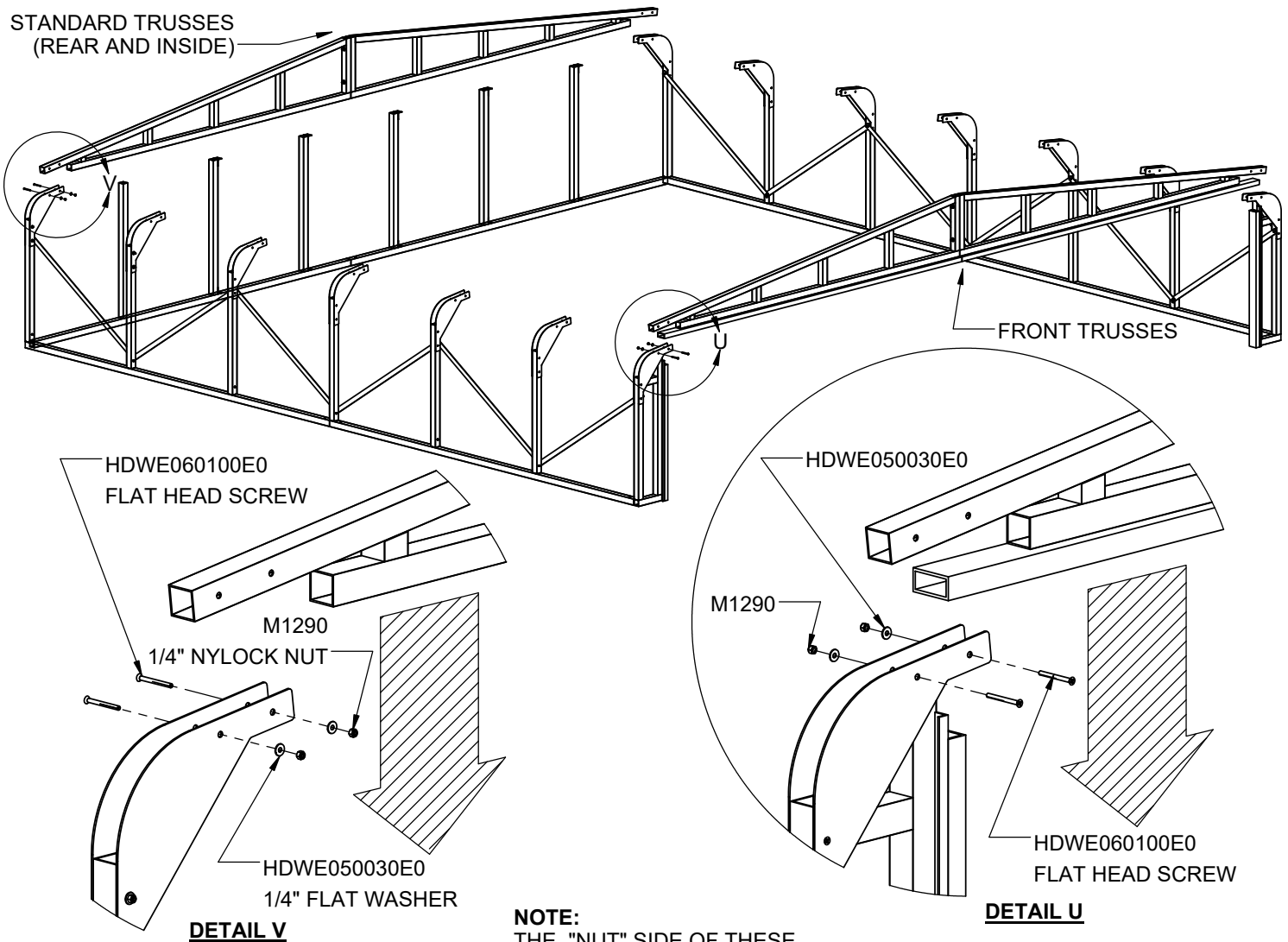

NOTE:
 THE "NUT" SIDE OF THESE
 CONNECTIONS MUST POINT
 TOWARDS EACH OTHER.

AT LEAST TWO PEOPLE ARE REQUIRED WHEN ADDING ALL STANDARD TRUSS ASSEMBLIES.

15. LOWER TRUSS ASSEMBLY IN PLACE. FASTEN EACH TRUSS USING TWO 5/16" HEX BOLTS, FOUR 5/16" FLAT WASHERS AND TWO 5/16" NYLOCK HEX NUTS.
16. REPEAT FOR ALL REMAINING TRUSSES.

NOTE: HAVE THE HARDWARE READY BEFORE PUTTING THE ASSEMBLED TRUSSES IN PLACE.

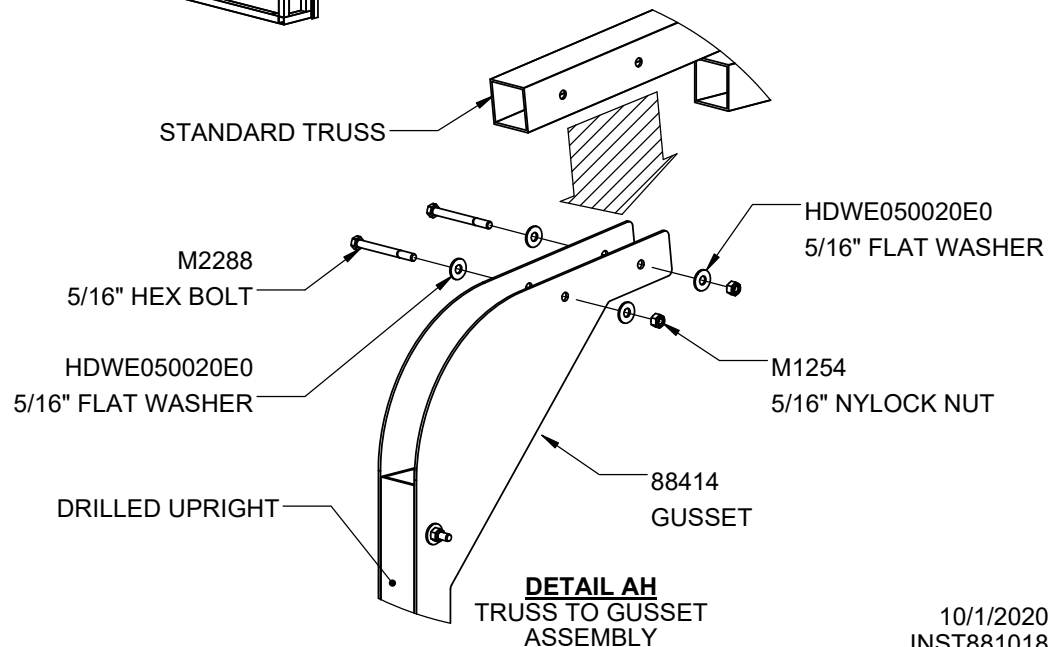
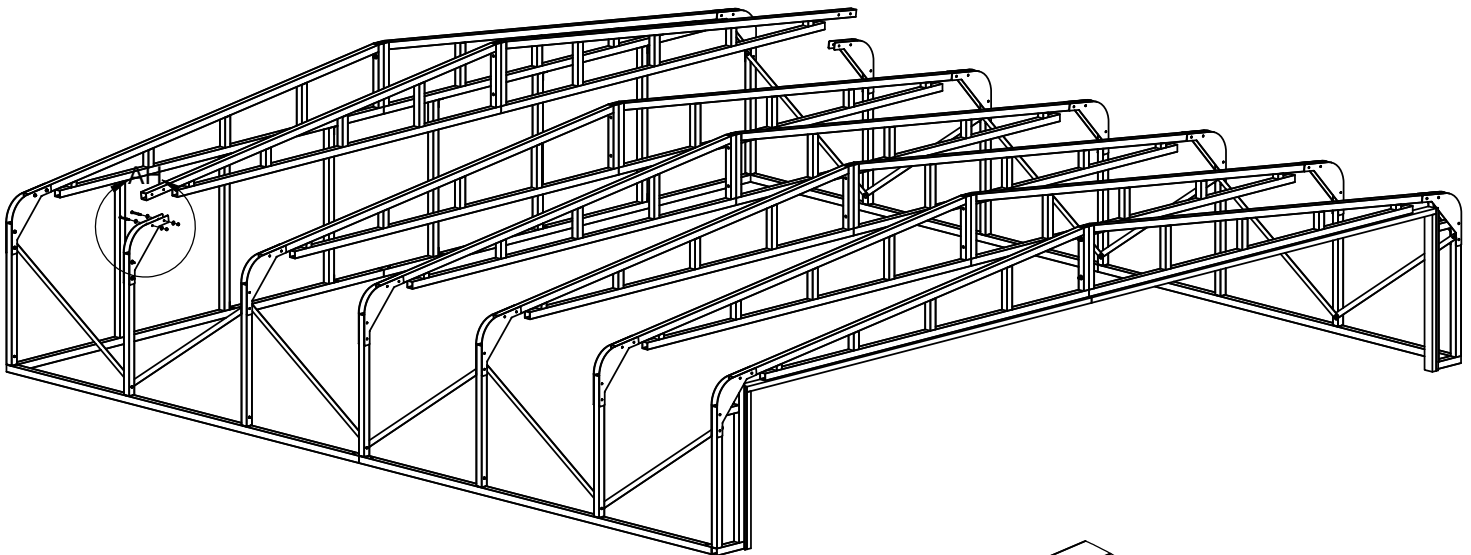

NOTE: USE A LEVEL OR A SQUARE TO MAKE SURE LEFT AND RIGHT FRONT CORNER WELDMENTS ARE SQUARE TO THE BOTTOM OF THE FRONT TRUSS BEFORE ADDING THE DIAGONAL FRONT BRACES. **DO NOT ADD DIAGONAL BRACES TO THE OUTSIDE OF GARAGE;** SIDING WILL NOT LAY FLAT IF INSTALLED ON OUTSIDE.

17. INSTALL DIAGONAL FRONT BRACES USING TWO 1" SELF DRILLING SCREWS TO THE INSIDE OF THE GARAGE. BRACES ONLY HAVE TWO PRE-DRILLED HOLES.
18. USE TWO MORE 1" SELF DRILLING SCREWS AS DEPICTED BELOW.

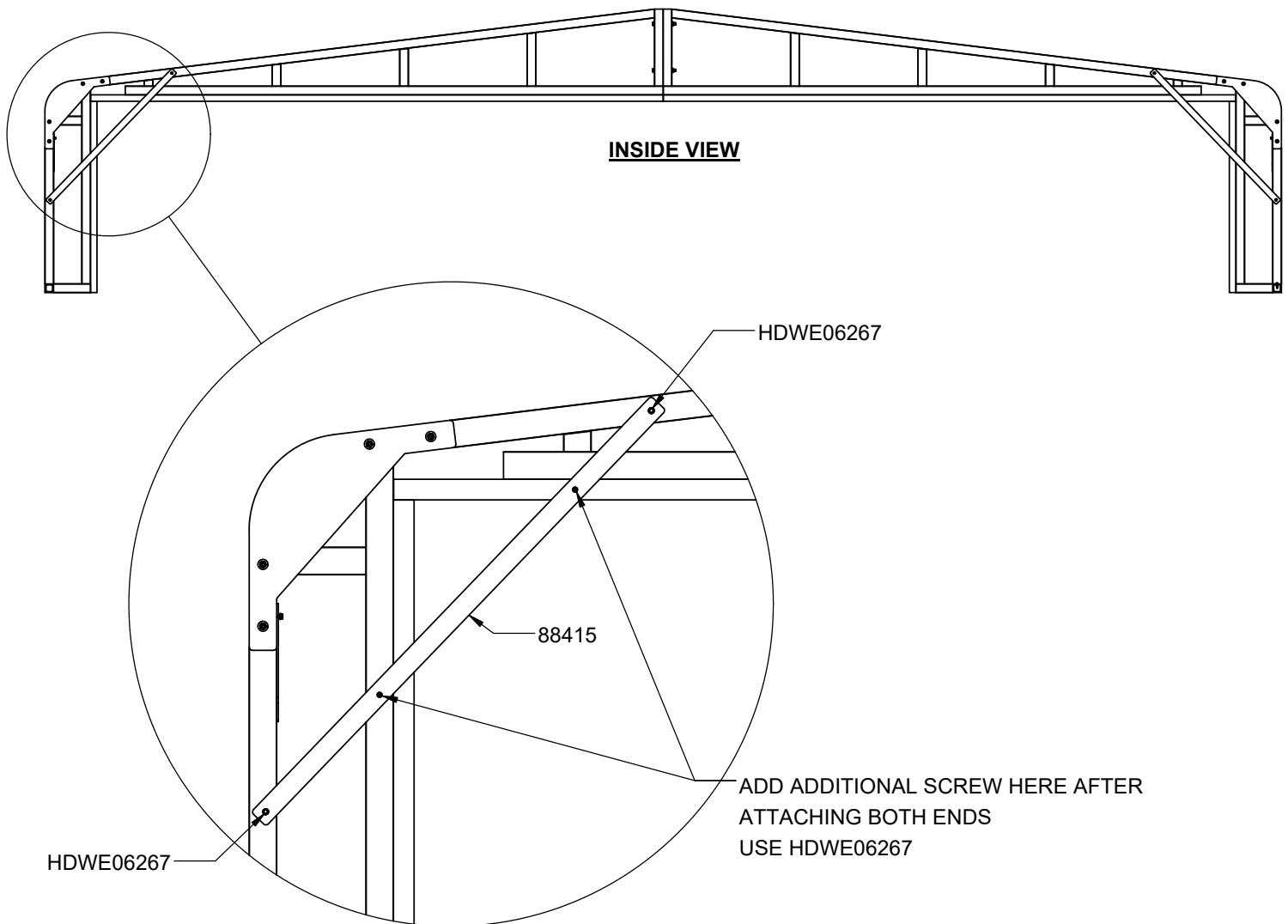

NOTE: ORIENTATION OF HINGES INSTALLED TO THE TOP OF THE DOOR FRAME IS CRUCIAL.

TOP VIEW

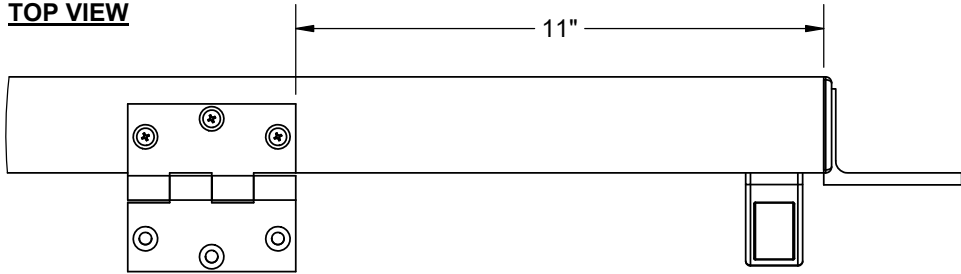

INSTALL PLASTIC PLUGS
INTO ALL FOUR OPEN
CORNERS OF EACH DOOR.

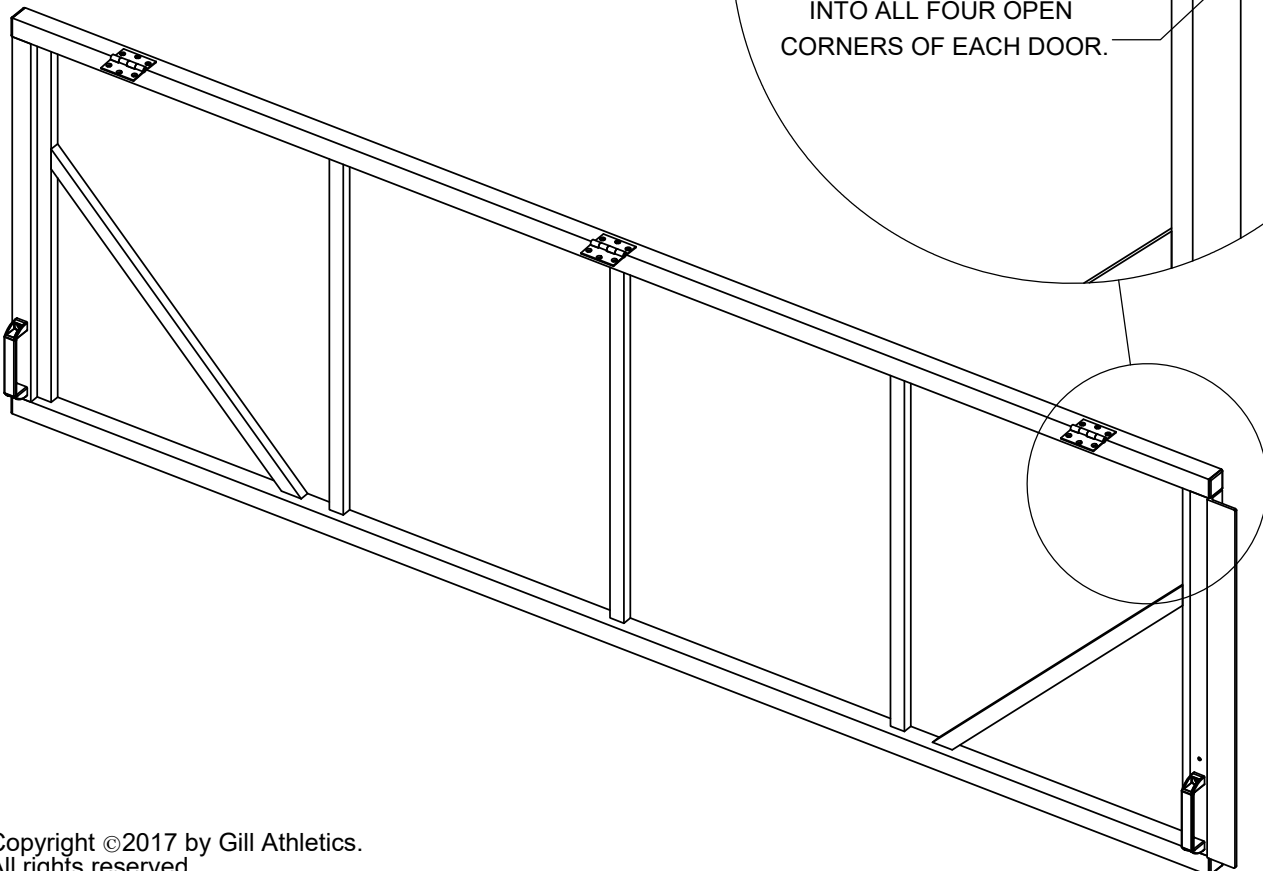



www.gillathletics.com
800-637-3090

881018, 881425, 882120, 883022 PIT GARAGE ASSEMBLY INSTRUCTIONS

AT LEAST TWO PEOPLE ARE REQUIRED WHEN ATTACHING DOORS.

19. ATTACH HINGES AS SHOWN BELOW USING #10 X 3/4" SELF DRILLING FLAT HEAD SCREWS. SCREW HINGE TO THE UNDERNEATH SIDE OF FRONT TRUSS. OPEN HINGE AS SHOWN IN **DETAIL CT** FOR CORRECT FRONT AND BACK LOCATION.
20. WHILE AT LEAST ONE PERSON HOLDS THE DOOR IN THE OPEN POSITION ATTACH OPEN SIDE OF HINGE TO THE DOOR FRAME.

NOTE: MAKE SURE THERE IS A 1" GAP BETWEEN CORNER FRAME AND DOOR FRAME AS WELL AS BETWEEN EACH DOOR (IF TWO DOORS ARE PRESENT) REFER TO NEXT PAGE FOR HINGE LAYOUT FOR YOUR GARAGE.

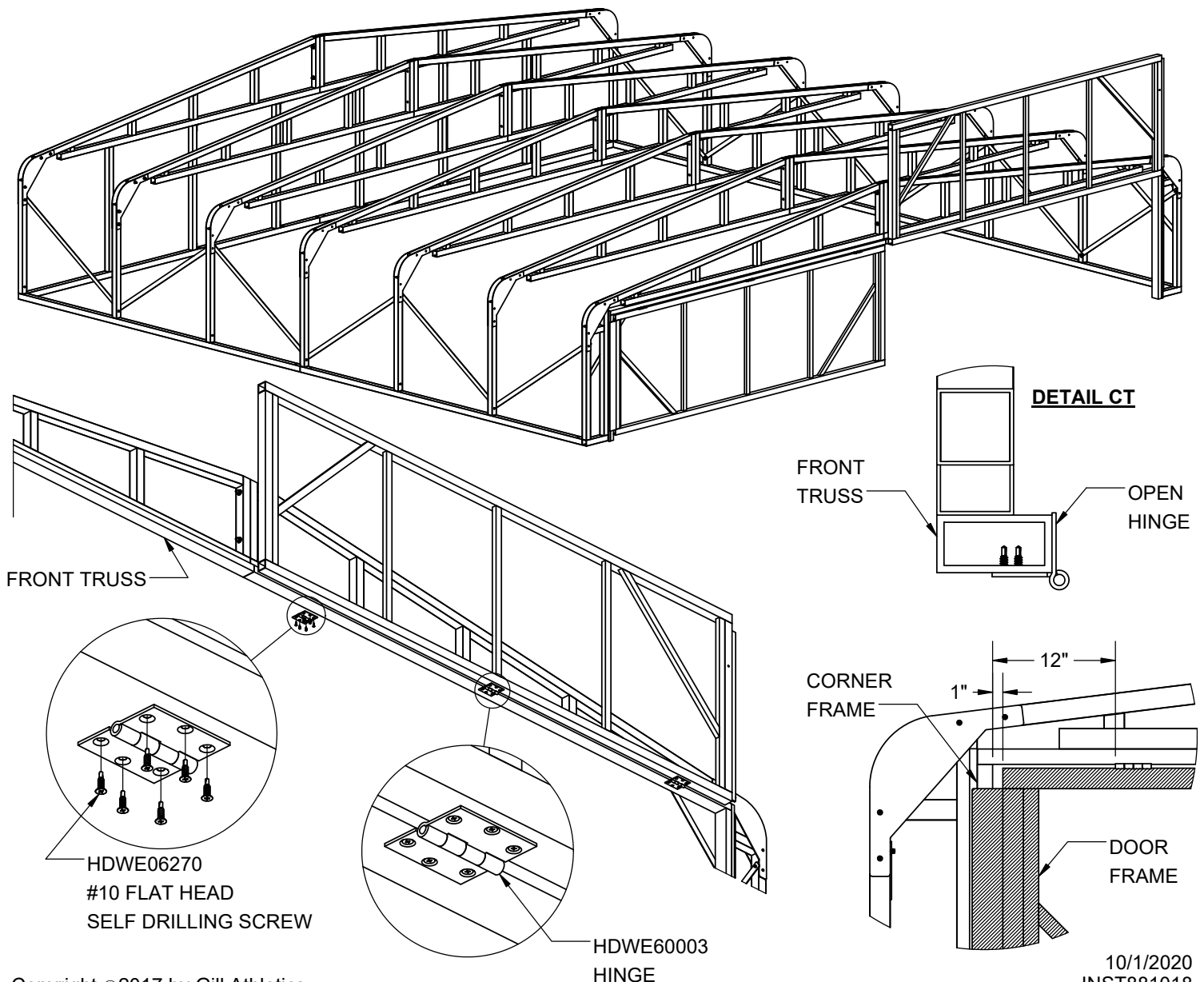



www.gillathletics.com
800-637-3090

881018, 881425, 882120, 883022 PIT GARAGE ASSEMBLY INSTRUCTIONS

AT LEAST TWO PEOPLE ARE REQUIRED WHEN ATTACHING DOORS.

NOTE: MAKE SURE THERE IS A 1" GAP BETWEEN CORNER FRAME AND DOOR FRAME AS WELL AS BETWEEN EACH DOOR (IF TWO DOORS ARE PRESENT)
LOOKING AT THE FRONT FROM THE SIDE, MAKE SURE TO LEAVE A GAP BETWEEN THE FRONT TRUSS AND THE DOOR FRAME AS LARGE AS THE DIAMETER OF THE HINGE'S SPINE.

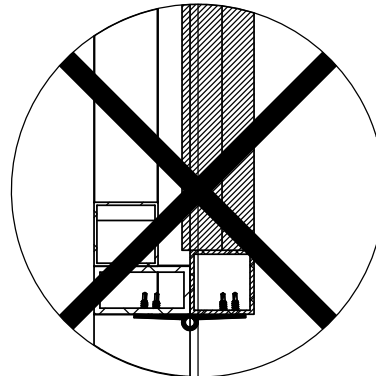
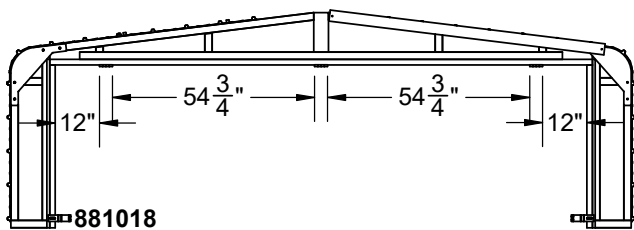

WRONG

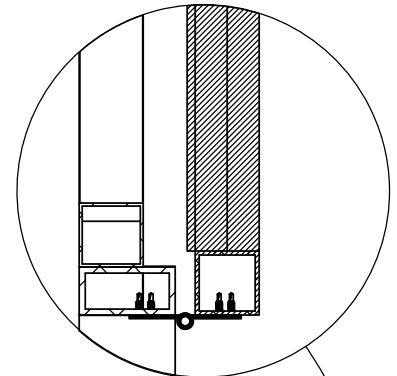

CORRECT
REFER TO **DETAIL CT**
ON PREVIOUS PAGE

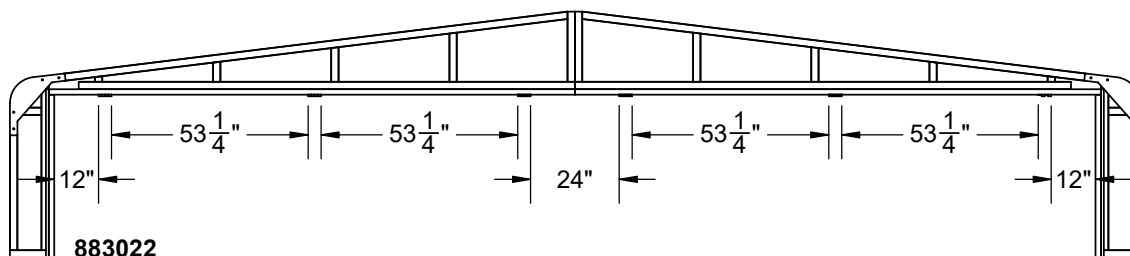
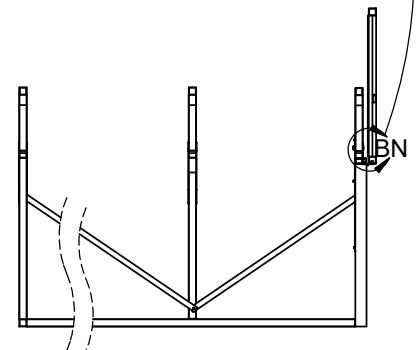
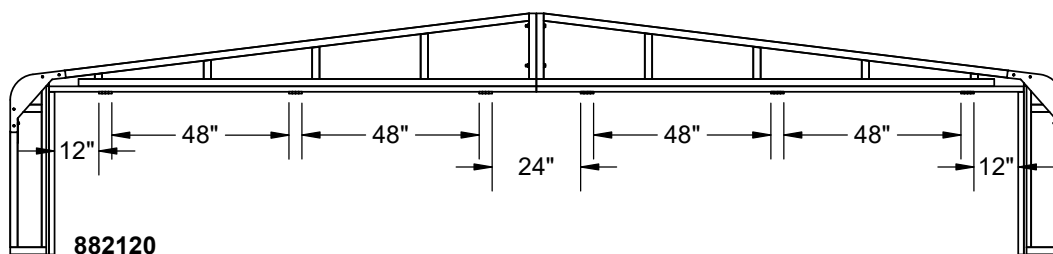
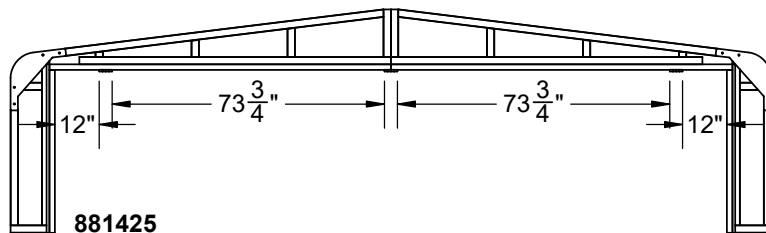

THIS SECTION IS ABOUT HOW TO INSTALL THE SIDING.

SPREAD A BEAD OF CLEAR OUTDOOR SILICONE BETWEEN EACH SHEET OF SIDING. NOTE THAT SILICON IS ONLY NEEDED THE SHORT WAY OF THE SIDING (SEE DETAIL BELOW).

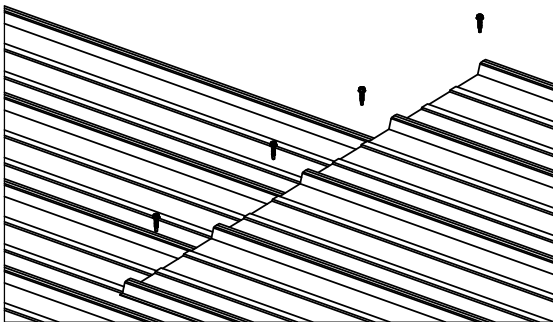
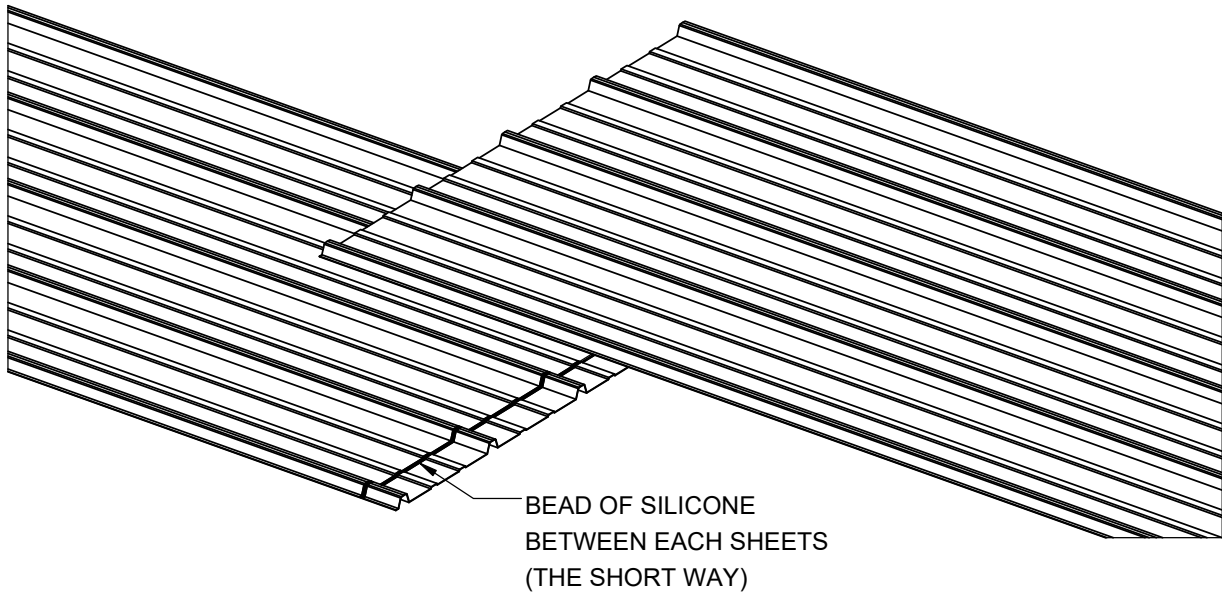

GENERAL SCREW LOCATIONS

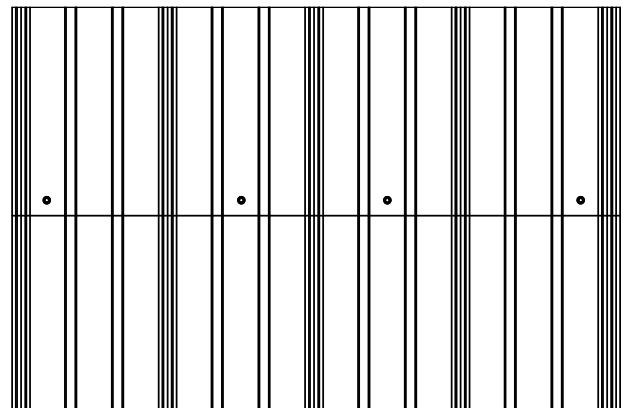
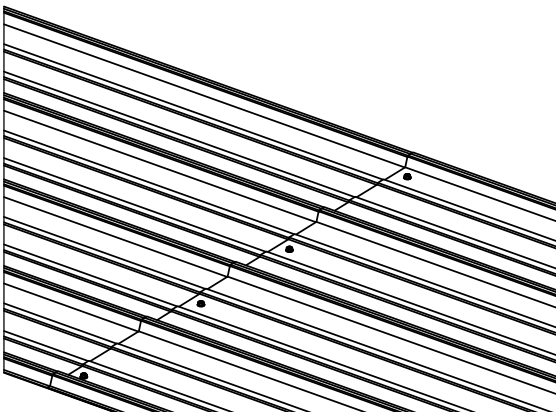
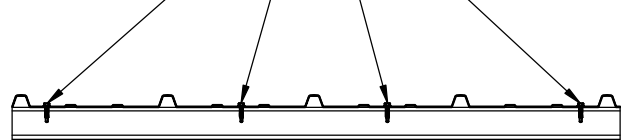

GILL RECOMMENDS AT LEAST TWO PEOPLE WHEN SKINNING THE GARAGE.

21. START ADDING SIDING TO THE LOWER BACK SIDE OF YOUR GARAGE.

NOTE: THIS MAY REQUIRE CUTTING THE SIDING DOWN THE LONG WAY DEPENDING ON THE SIZE OF YOUR GARAGE.

USE EXTREME CAUTION WHEN CUTTING SIDING TO PREVENT CUTS OR OTHER INJURIES.

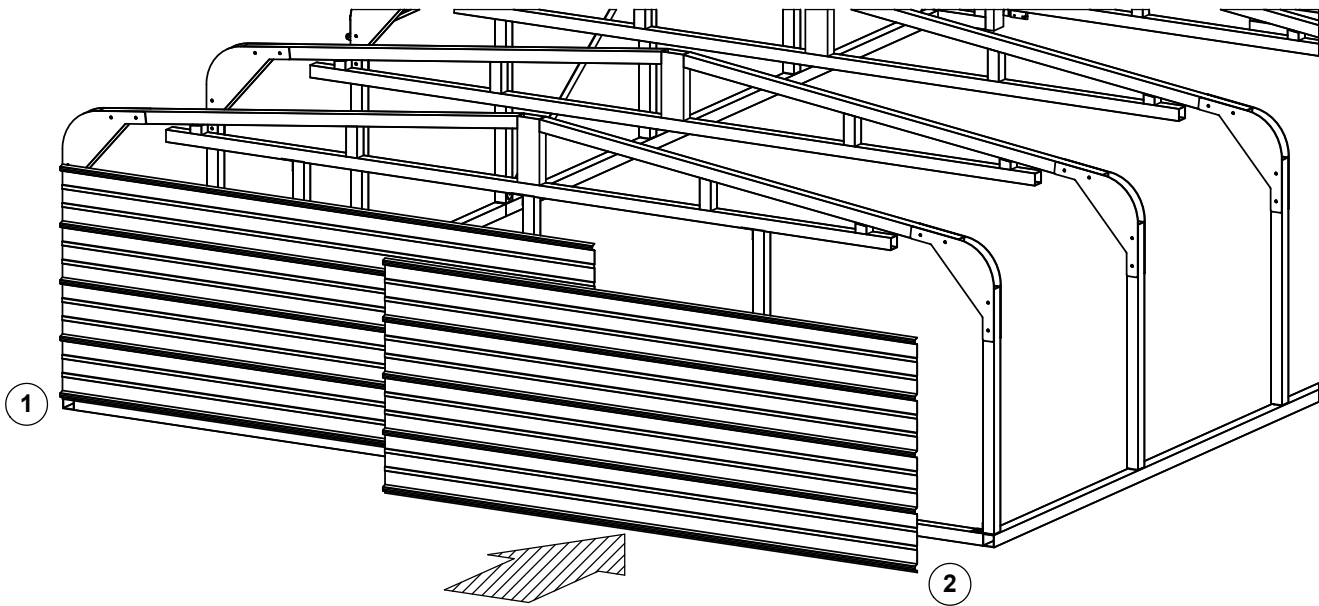

22. NEXT, ADD THE UPPER PIECES OF SIDING. THIS WILL REQUIRE CUTTING THE SIDING. HOLD THE FIRST SHEET TO BE CUT UP TO WHERE IT NEEDS TO BE INSTALLED. USING A SHARPIE, MARK THE BACKSIDE OF THE SIDING DOWN THE SLOPE AND THE ROUNDED CORNER. CUT THE PIECE ON THE GROUND AND INSTALL USING 1" SELF DRILLING SCREWS.

NOTE: **USE EXTREME CAUTION WHEN CUTTING SIDING** TO PREVENT CUTS OR OTHER INJURIES.

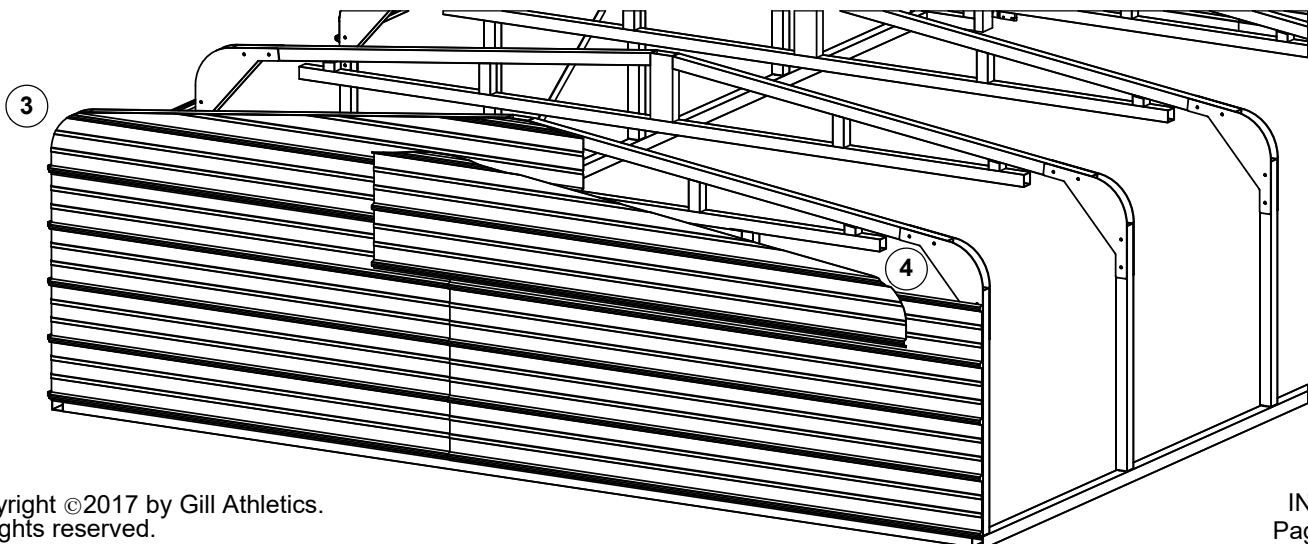

GILL RECOMMENDS AT LEAST TWO PEOPLE WHEN SKINNING THE GARAGE.

23. INSTALL THE TOP TWO PIECES AT THE FRONT OF THE GARAGE FIRST. HOLD TOP PIECE ON ONE SIDE IN PLACE ALIGNING IT WITH THE SIDE OF THE GARAGE AND RESTING IT ON TOP OF THE DOOR HEADER (SEE HATCHED AREA IN **DETAIL BP**).

MARK THE BACKSIDE OF THE SIDING DOWN THE SLOPE AND THE ROUNDED CORNER. CUT THE PIECE ON THE GROUND AND INSTALL USING 1" SELF DRILLING SCREWS.

NOTE: USE EXTREME CAUTION WHEN CUTTING SIDING TO PREVENT CUTS OR OTHER INJURIES.

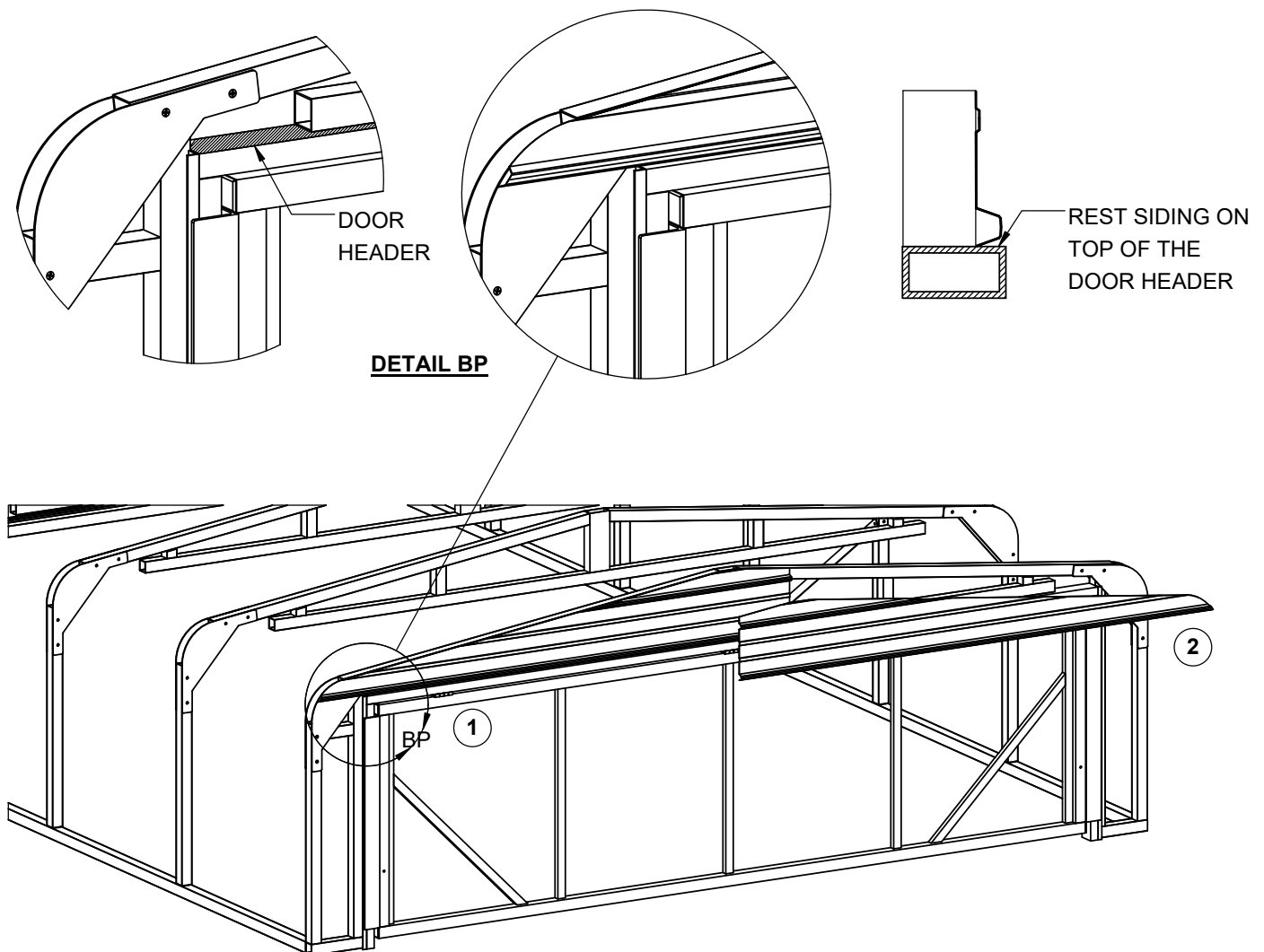

GILL RECOMMENDS AT LEAST TWO PEOPLE WHEN SKINNING THE GARAGE.

24. CUT TWO 10" STRIPS OF SIDING FOR THE LEFT AND THE RIGHT SIDE NEXT TO THE DOOR. SLIDE EACH PIECE INTO THE SIDING CHANNEL AND TUCK IT UNDER THE PREVIOUSLY CUT PIECE ABOVE. FASTEN USING 1" SELF DRILLING SCREWS.

NOTE: USE EXTREME CAUTION WHEN CUTTING SIDING TO PREVENT CUTS OR OTHER INJURIES.

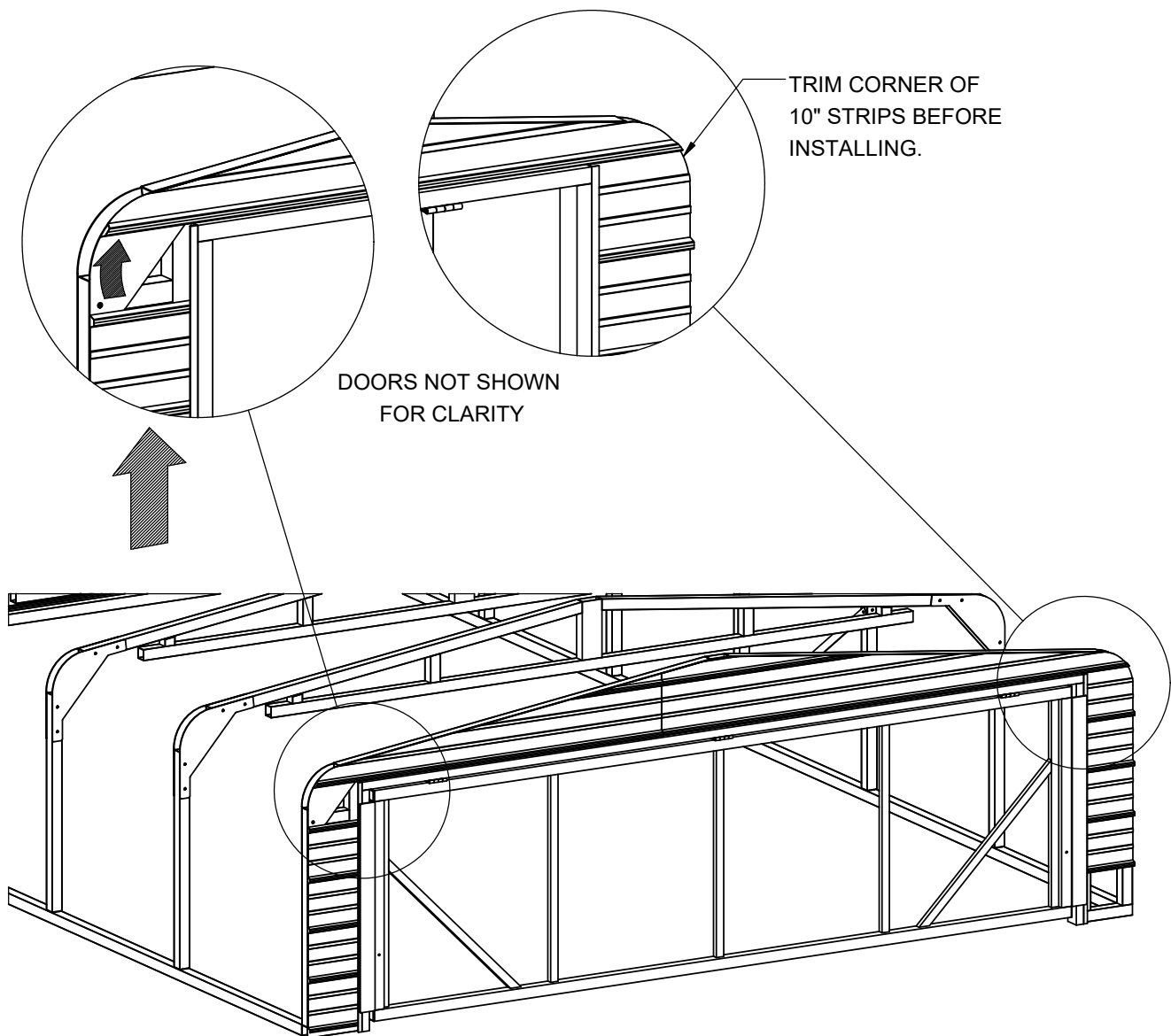

GILL RECOMMENDS AT LEAST TWO PEOPLE WHEN SKINNING THE GARAGE.

25. CUT TWO 10" STRIPS OF SIDING FOR THE LEFT AND THE RIGHT BOTTOM CORNERS. SLIDE EACH PIECE INTO THE SIDING CHANNEL AND TUCK IT UNDER THE PREVIOUSLY CUT PIECE ABOVE. FASTEN USING 1" SELF DRILLING SCREWS.

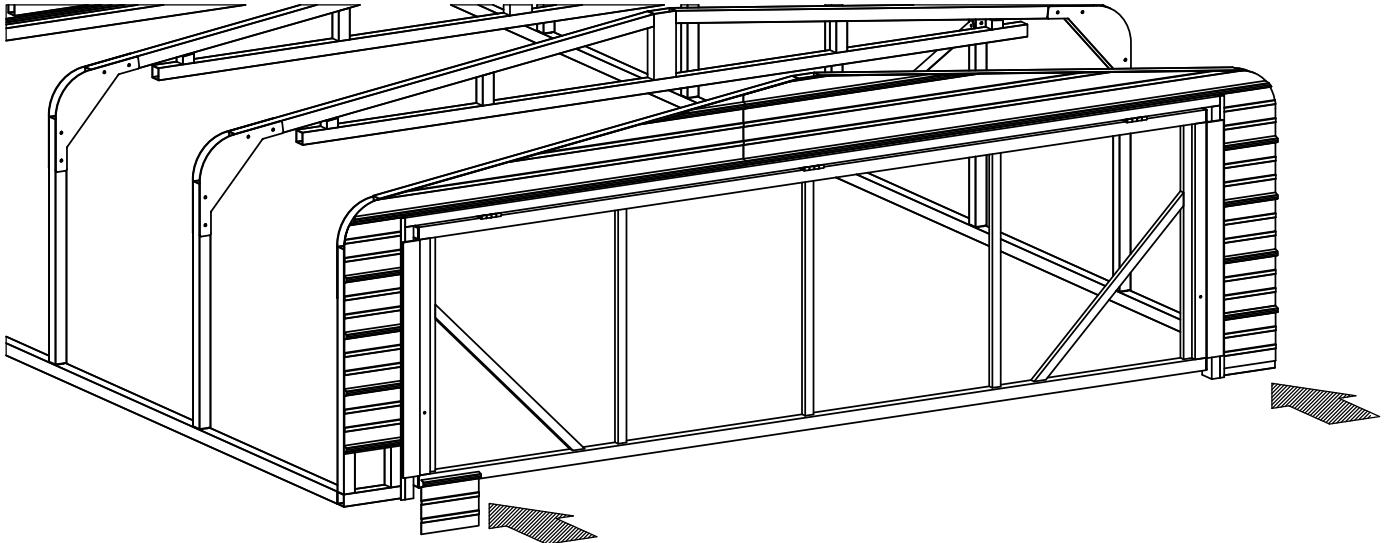

26. PLACE A SHEET OF SIDING ONTO THE RECESSED FRAME OF THE DOOR(S) AND HOLD IN PLACE. SLIDE THAT PIECE ALL THE WAY TO ONE SIDE OF THE DOOR FRAME. ADD THE SECOND PIECE ON TOP OF THE FIRST AND SLIDE TO THE OPPOSITE SIDE OF THE FRAME. FASTEN DOWN USING 1" SELF DRILLING SCREWS.

NOTE: GILL RECOMMENDS TWO PEOPLE FOR THIS STEP. CUTTING THE SECOND PIECE OF SIDING IS OPTIONAL.

USE EXTREME CAUTION WHEN CUTTING SIDING TO PREVENT CUTS OR OTHER INJURIES.

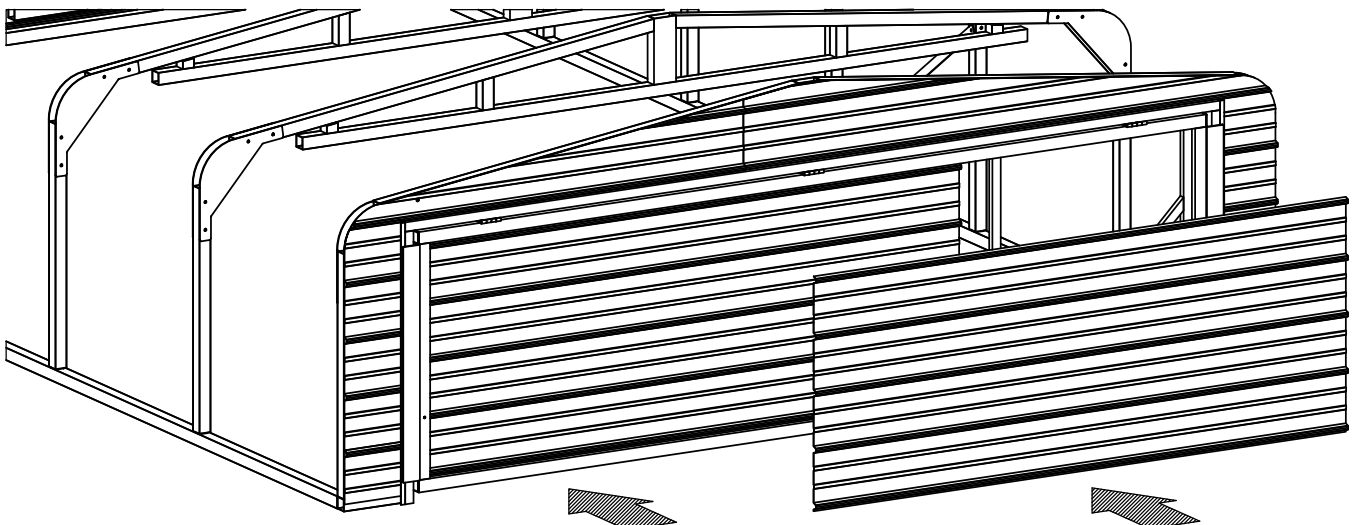

GILL RECOMMENDS AT LEAST TWO PEOPLE WHEN SKINNING THE GARAGE.

27. ADD FIRST 8' PIECE OF SIDING STARTING AT THE BACK OF THE GARAGE. ALIGN THE CENTER HUMP OF THE SIDING WITH THE CENTER OF THE GARAGE (881018 PIT GARAGE SHOWN).

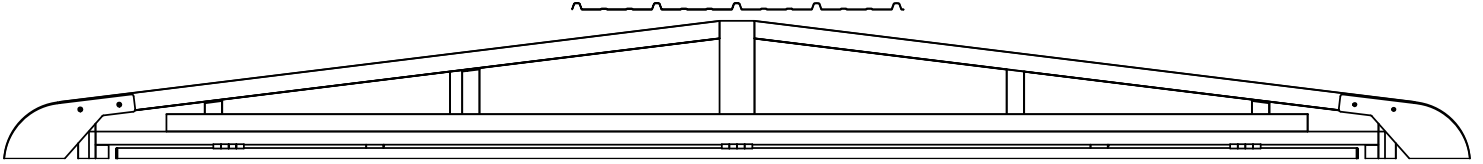

28. USE 1" SELF DRILLING SCREWS TO FASTEN THE SIDING TO THE FRAME.

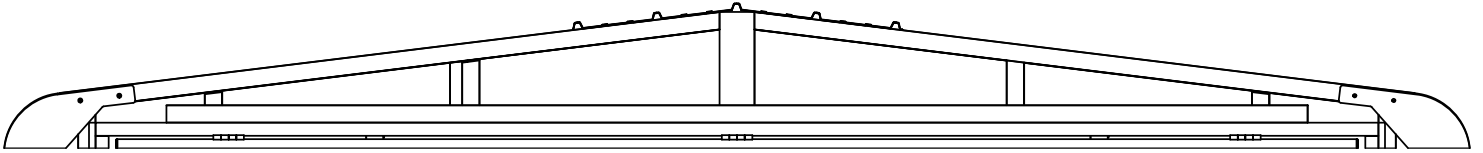

29. WORK YOUR WAY TO THE FRONT OF THE GARAGE AS SHOWN BELOW.

NOTE: YOU MIGHT HAVE TO CUT PIECES OF SIDING IN HALF DEPENDING ON YOUR SIZE GARAGE.
USE EXTREME CAUTION WHEN CUTTING SIDING TO PREVENT CUTS OR OTHER INJURIES.

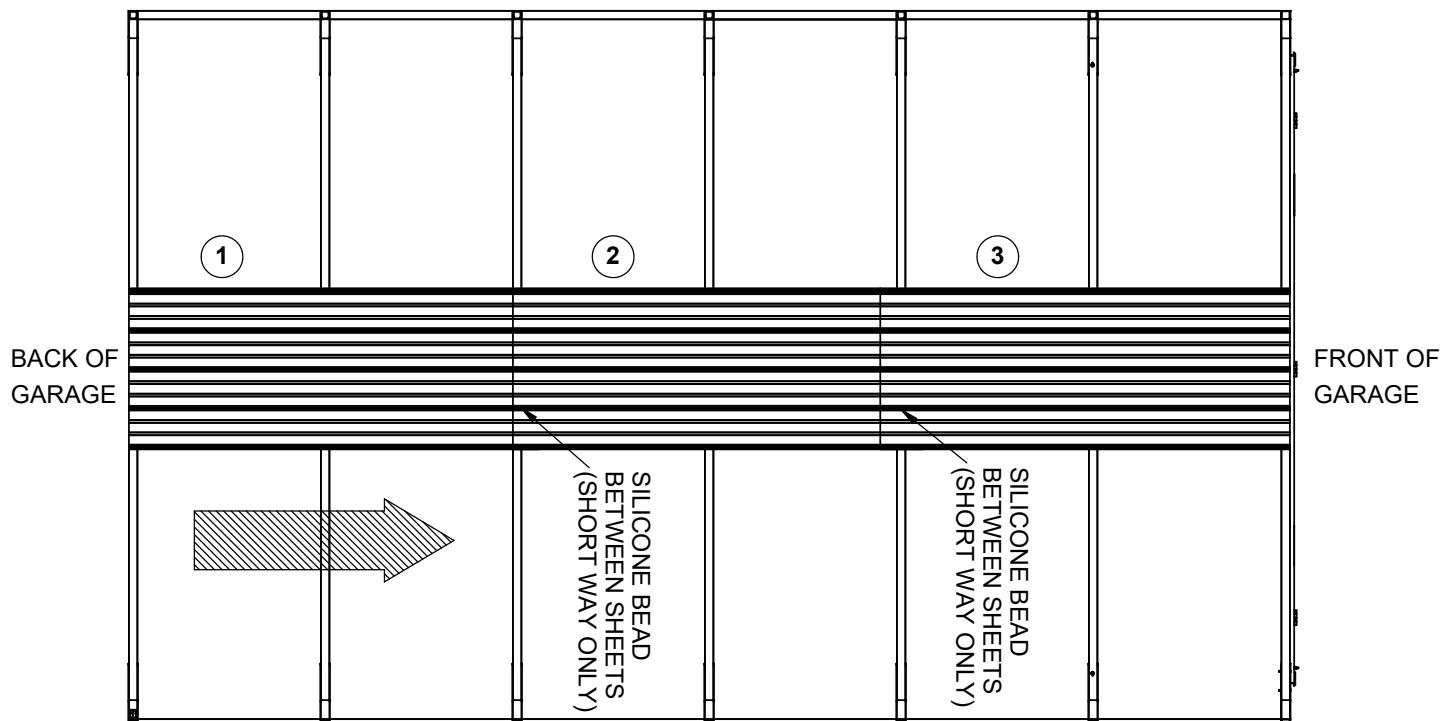

GILL RECOMMENDS AT LEAST TWO PEOPLE WHEN SKINNING THE GARAGE.

30. APPLY NEXT ROW OF SIDING TO THE LEFT AND RIGHT GOING DOWN THE SLOPE AS SHOWN BELOW.
 START THIS ROW WITH A 4' PIECE OF SIDING TO STAGGER THE SEAMS (8' PANELS PROVIDED, CUT IN FIELD).

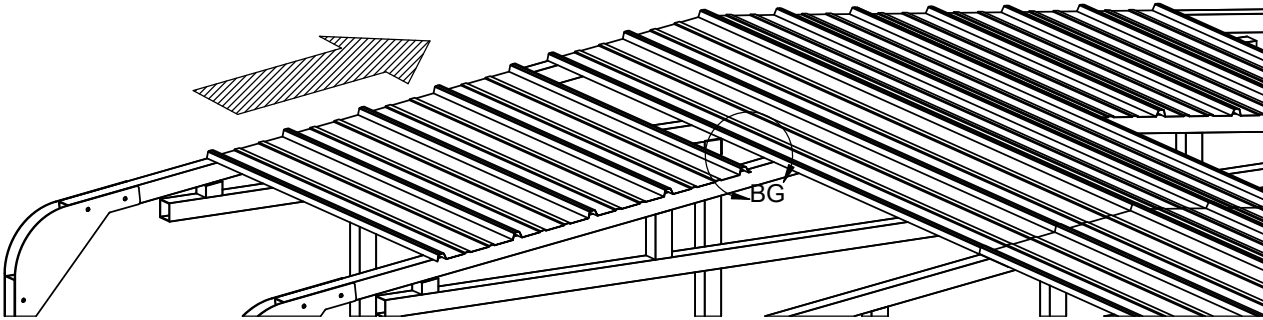

31. SLIDE NEXT PIECE OF SIDING UNDERNEATH OUTSIDE HUMP OF LAST INSTALLED SIDING.
 32. APPLY A BEAD OF SILICONE BEFORE ADDING EACH SHEET OF SIDING.

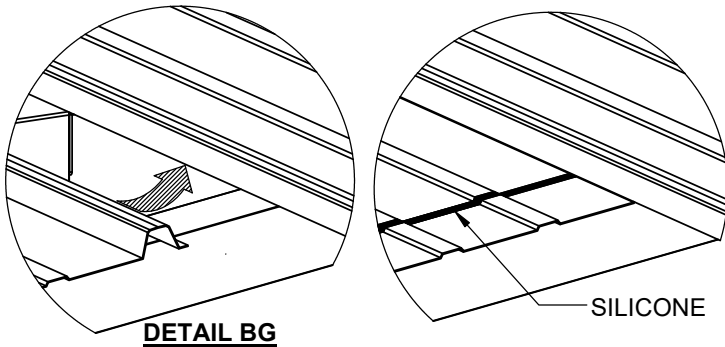

NOTE: USE CLEAR OUTDOOR SILICONE FOR WINDOWS AND SIDING.
 SILICONE IS ONLY NEEDED ON THE ROOF PORTION OF YOUR GARAGE.

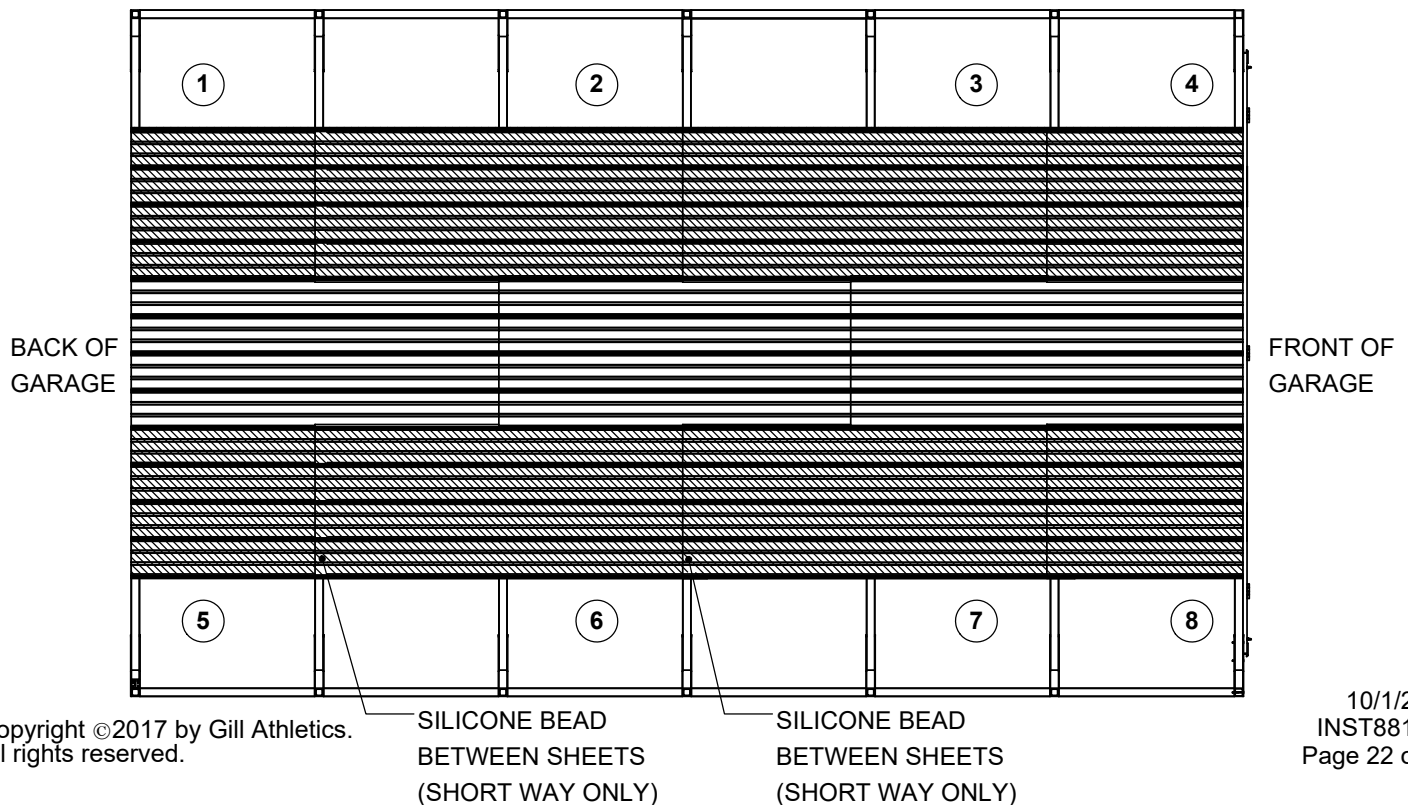

GILL RECOMMENDS AT LEAST TWO PEOPLE WHEN SKINNING THE GARAGE.

33. APPLY NEXT ROW OF SIDING TO THE LEFT AND RIGHT GOING DOWN THE SLOPE AS SHOWN BELOW.

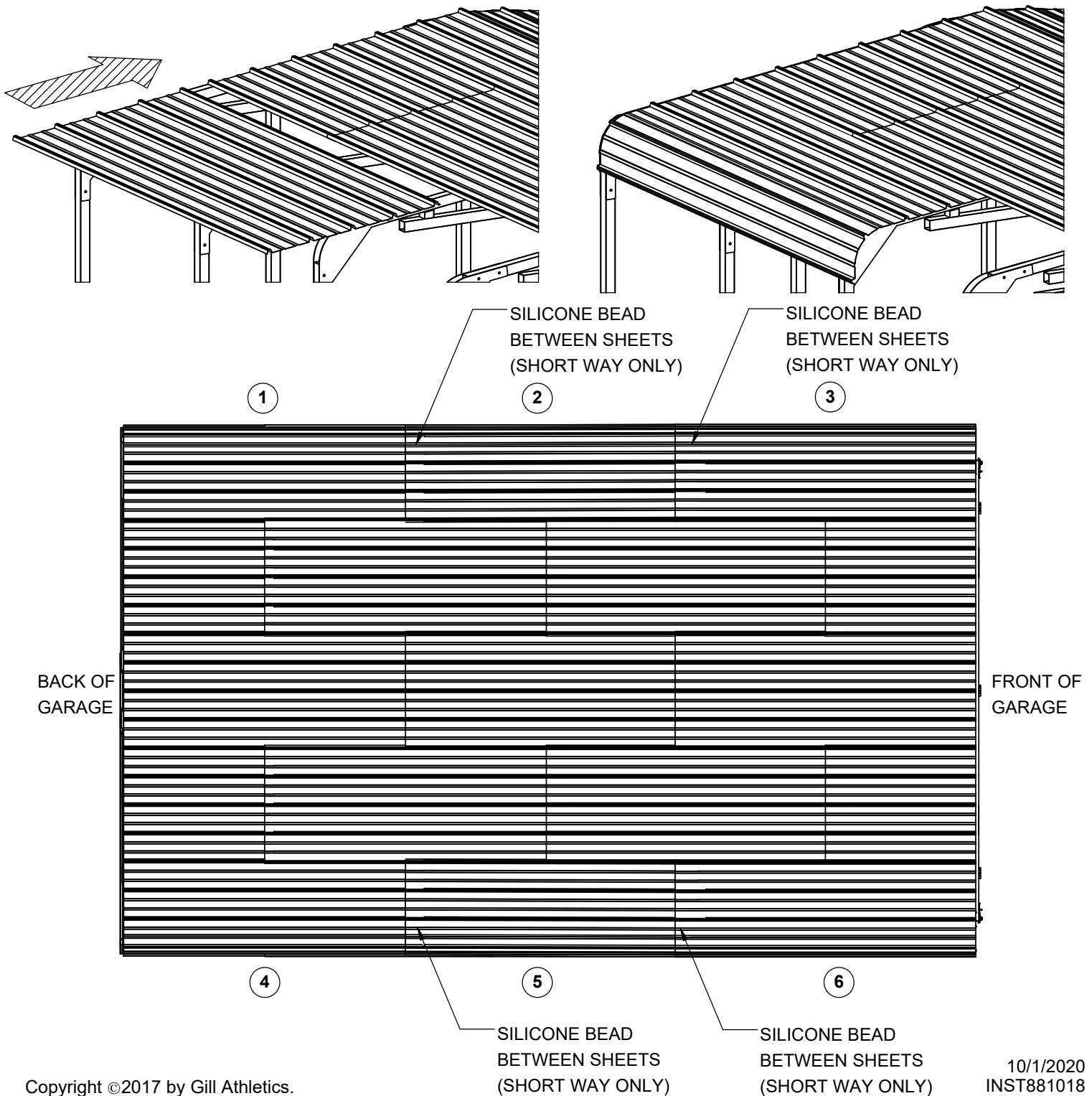

GILL RECOMMENDS AT LEAST TWO PEOPLE WHEN SKINNING THE GARAGE.

34. START ADDING SIDING DOWN THE BOTTOM LEFT AND RIGHT SIDES. USE A HALF OR FULL SHEET TO STAGGER THE SIDING DEPENDING ON YOUR PREVIOUS ROW.

NOTE: THIS MAY REQUIRE CUTTING THE SIDING DOWN THE LONG WAY DEPENDING ON THE SIZE OF YOUR GARAGE.

USE EXTREME CAUTION WHEN CUTTING SIDING TO PREVENT CUTS OR OTHER INJURIES.

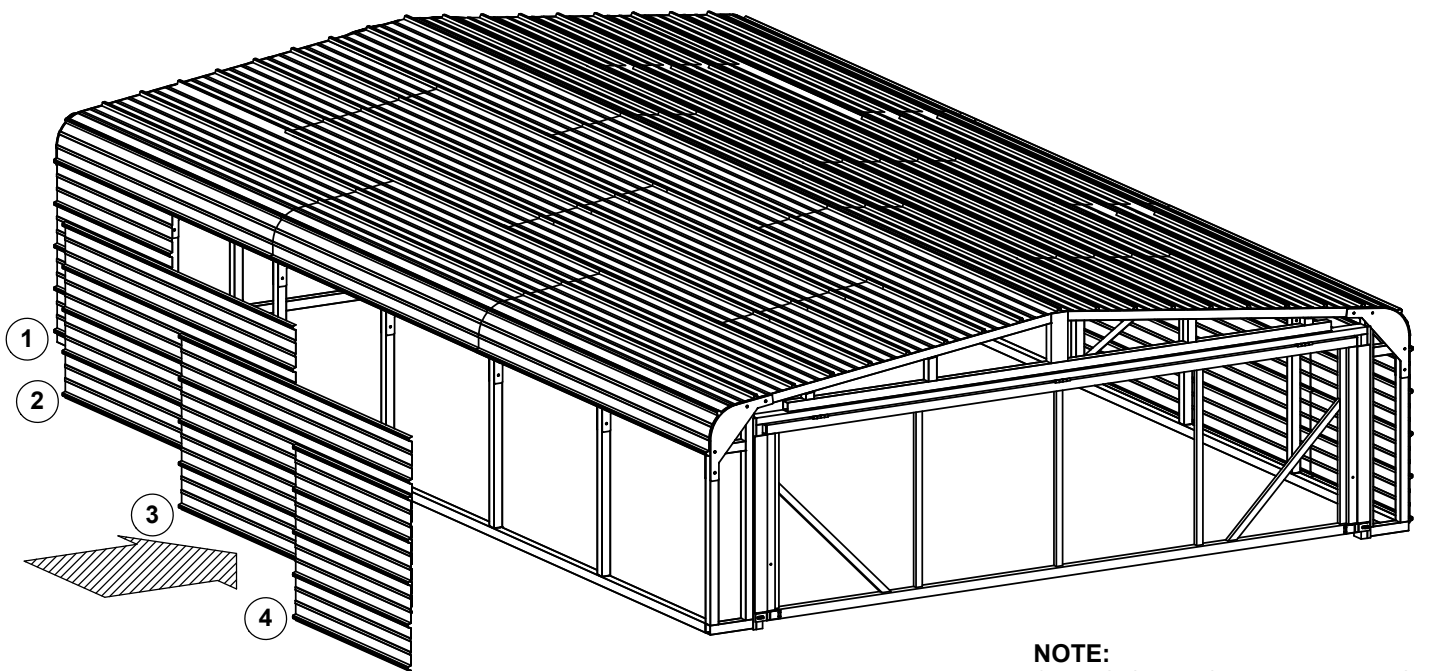

NOTE:
SIDING ON FRONT AND REAR OF
GARAGE HIDDEN FOR CLARITY.

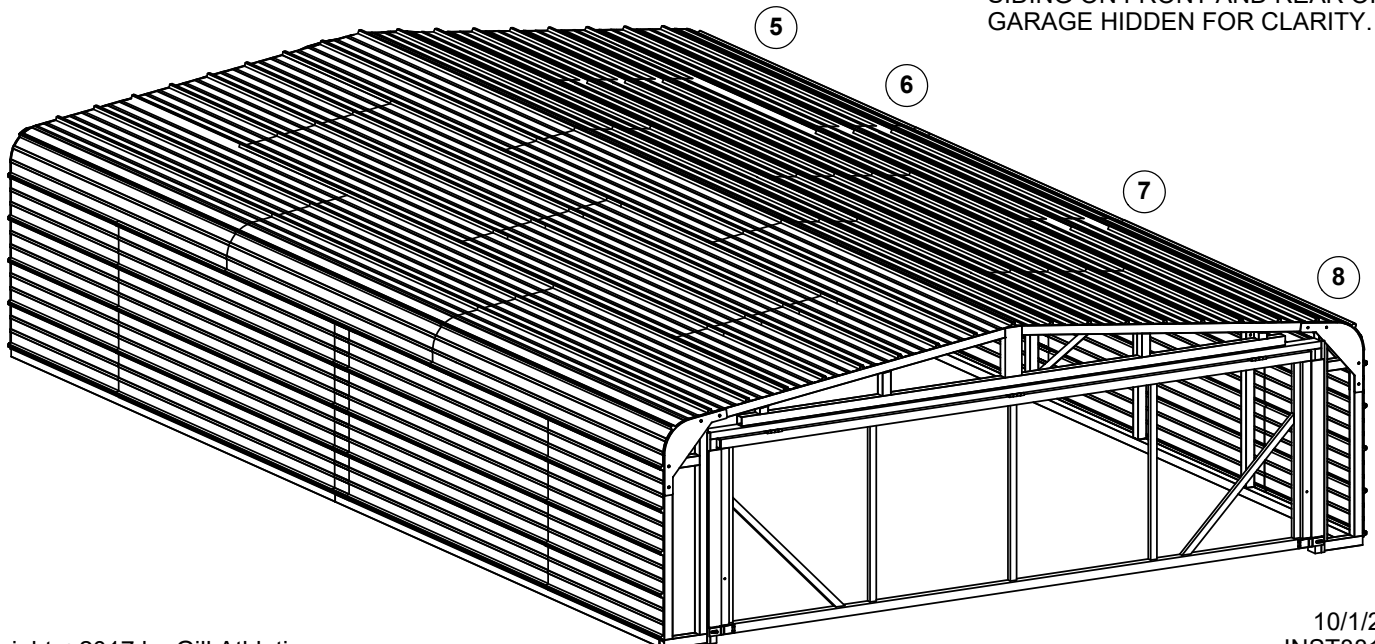

NOTE: DO THE FOLLOWING WHEN INSTALLING SHORT TRIM ANGLES. HOLD EACH ANGLE (ONE BY ONE) AGAINST THE GARAGE CORNERS. MARK THE SPOT TO PRE-DRILL FOR THE 2" SELF DRILLING SCREWS. BE SURE TO MAKE THOSE MARKS ON LOW SPOTS. DRILL 1/4" HOLES CENTERED (DOWN THE LENGTH OF THE ANGLES) AND INSTALL ANGLES AS SHOWN IN **DETAIL BW**.

35. ATTACH THE SHORTER OF THE TWO WHITE ANGLES TO EACH CORNER OF THE GARAGE. FASTEN USING SIX 1" SELF DRILLING SCREWS AND PLASTIC SPACERS.

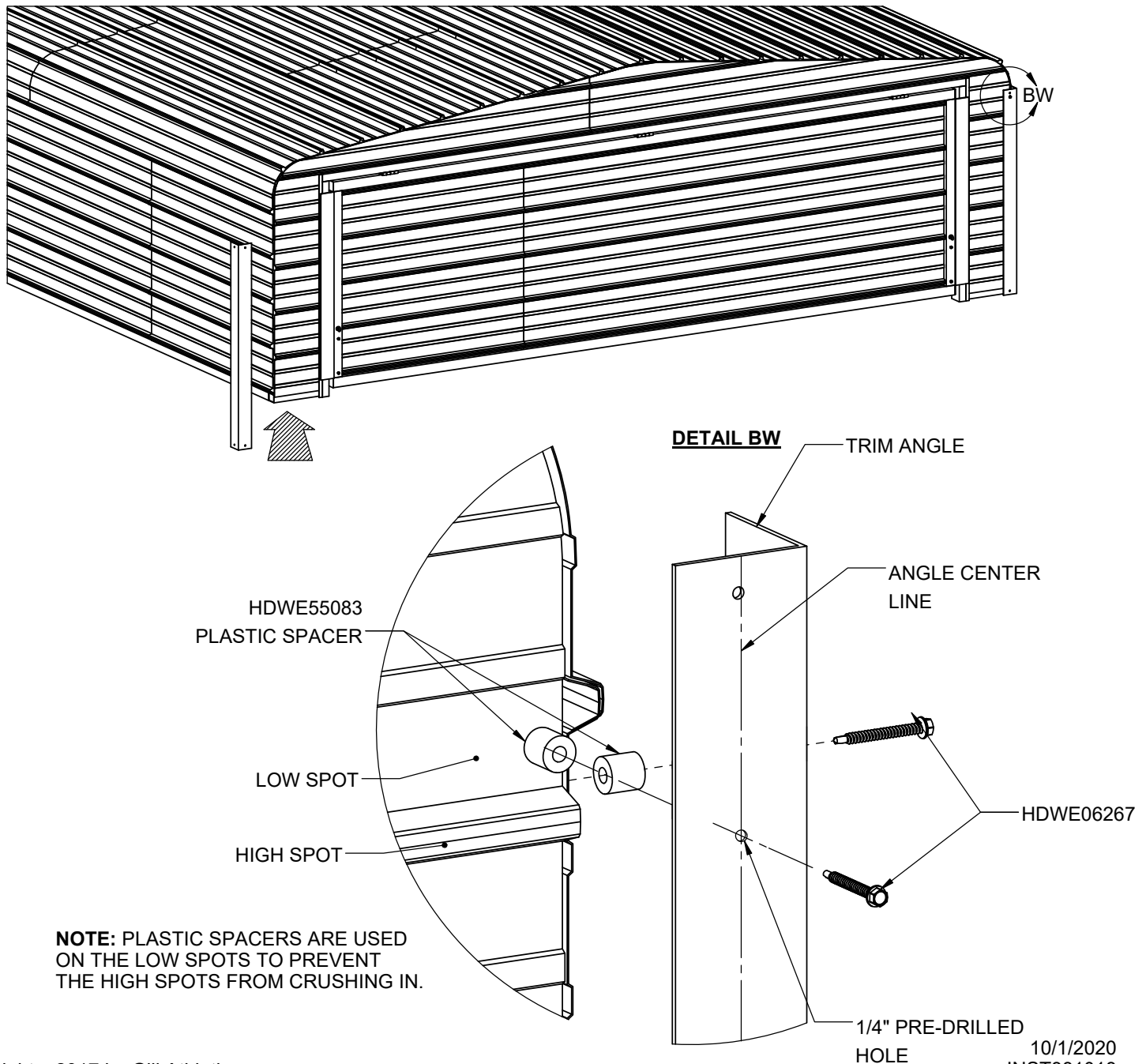



www.gillathletics.com
800-637-3090

881018, 881425, 882120, 883022 PIT GARAGE ASSEMBLY INSTRUCTIONS

NOTE: DO THE FOLLOWING WHEN INSTALLING LONG TRIM ANGLES. HOLD EACH ANGLE (ONE BY ONE) AGAINST THE GARAGE CORNER SLOPE. MARK THE SPOT TO PRE-DRILL FOR THE 2" SELF DRILLING SCREWS. BE SURE TO MAKE THOSE MARKS ON LOW SPOTS. DRILL 1/4" HOLES AND INSTALL ANGLES AS SHOWN IN **DETAIL BW**.

36. ATTACH THE LONGER OF THE TWO WHITE ANGLES TO EACH SLOPED CORNER OF THE GARAGE THE SAME WAY AS THE SHORT TRIM ANGLES ON PREVIOUS PAGE (REFER BACK TO **DETAIL BW**). KEEP TOP EDGE ABOUT 3"-4" FROM THE GARAGE CENTER (SEE **DETAIL CB**). FASTEN USING 2" SELF DRILLING SCREWS AND PLASTIC SPACERS EVERY 16"-24".

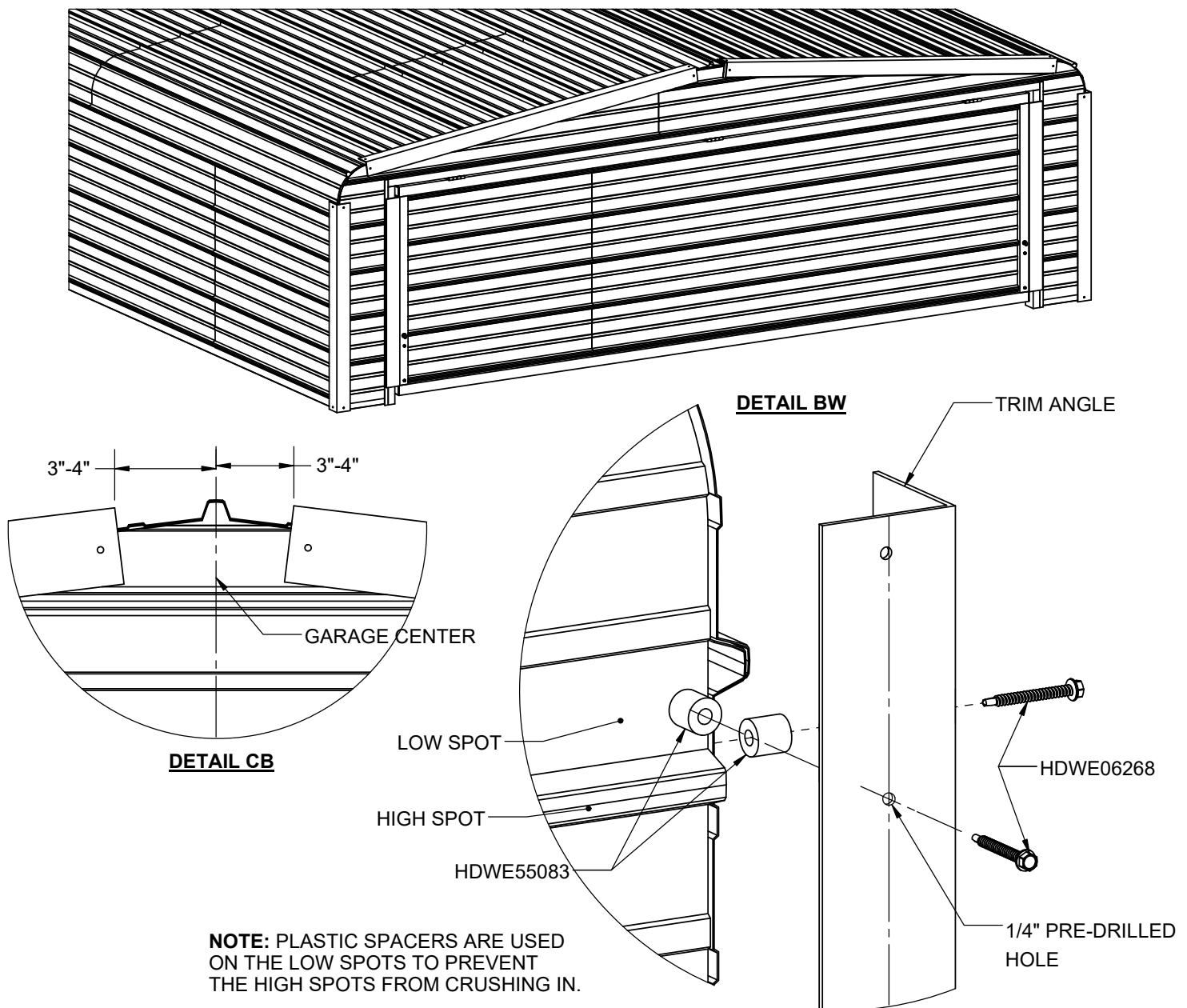

37. INSTALL THE CORNER AND GABLE TRIM PIECES. PLACE THE CORNER AND GABLE PIECES ON TOP OF THE TRIM ANGLES. SLIDE A PLASTIC SPACER UNDERNEATH THE TRIM ANGLES RIGHT BELOW THE HOLE IN EACH CORNER AND GABLE PIECE. DRIVE 1" SELF DRILLING SCREWS THROUGH THE HOLE INTO THE ANGLE (SEE **DETAIL CE**).

NOTE: INSTALL GABLE PIECES THE SAME WAY AS THE CORNER PIECES SHOWN IN **DETAIL CE**.
 DO NOT OVERTIGHTEN SCREWS TO PREVENT PLASTIC CORNERS AND GABLE PIECES FROM CRACKING.

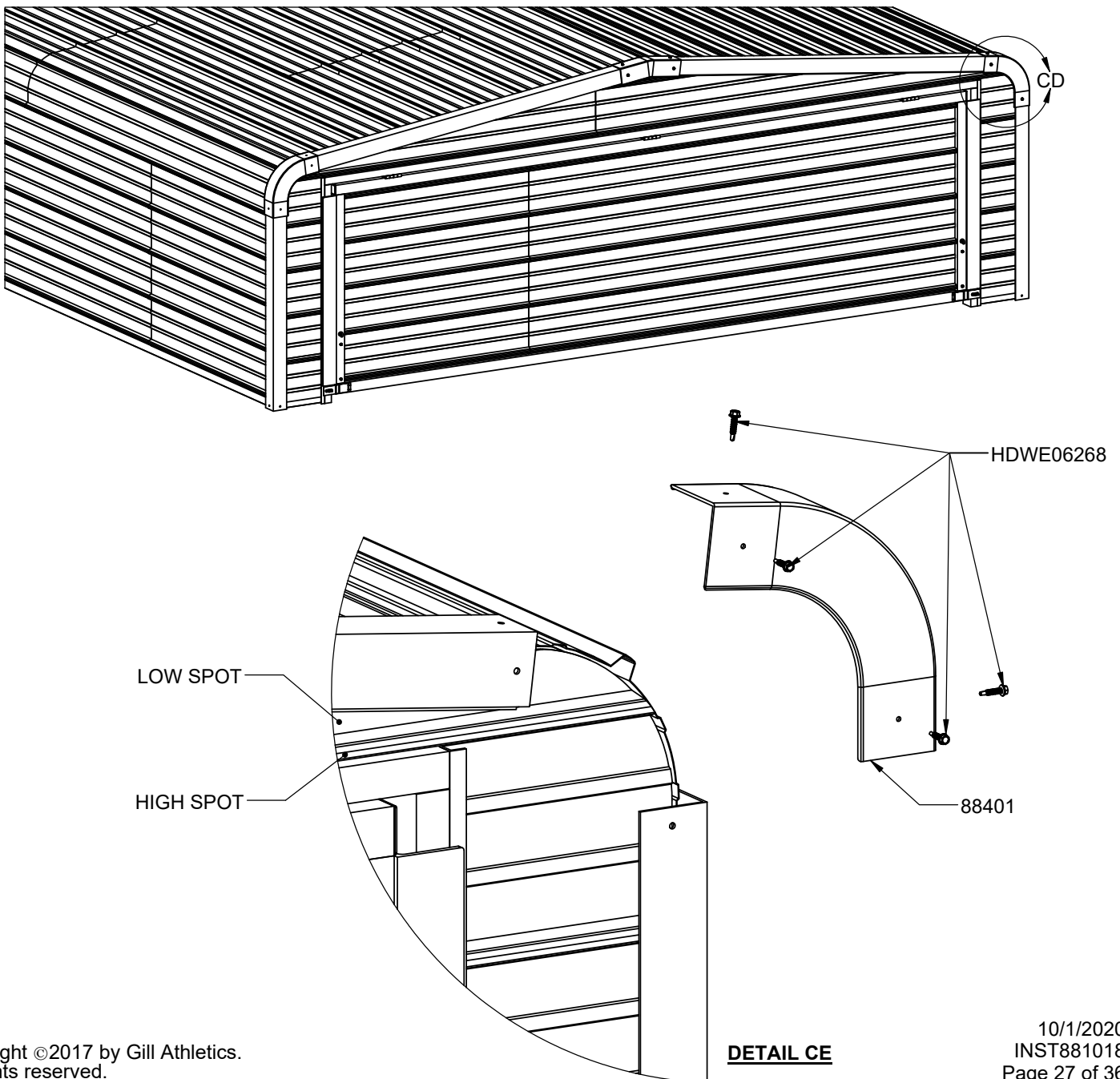



www.gillathletics.com
800-637-3090

881018, 881425, 882120, 883022 PIT GARAGE ASSEMBLY INSTRUCTIONS

38. INSTALL ONE HANDLE AT EACH BOTTOM CORNER OF THE DOOR (ONE HANDLE PER DOOR IF YOUR GARAGE HAS TWO DOORS IN WHICH CASE INSTALL HANDLE TO THE LEFT SIDE OF THE LEFT DOOR AND TO THE RIGHT SIDE OF THE RIGHT DOOR). USE TWO 2" SELF DRILLING SCREWS. ATTACH HANDLE 3" FROM THE BOTTOM OF THE DOOR FRAME TO THE CENTER OF THE BOTTOM HOLE IN THE HANDLE (SEE **DETAIL CF**).
39. ATTACH EYEBOLTS TO THE DOORS AS SHOWN BELOW.
40. DRILL A 5/16" HOLE THROUGH THE SIDING AND THE 2ND ROOF FRAME FOR THE 1/4" EYEBOLT WHICH WILL HOLD THE DOOR CHAIN (SEE **DETAIL CM**).

NOTE: ALIGN THE HOLE FOR THE ROOF EYEBOLT WITH THE LEFT AND RIGHT DOOR EDGE. ONLY ONE EYEBOLT NEEDED AT EACH SIDE.

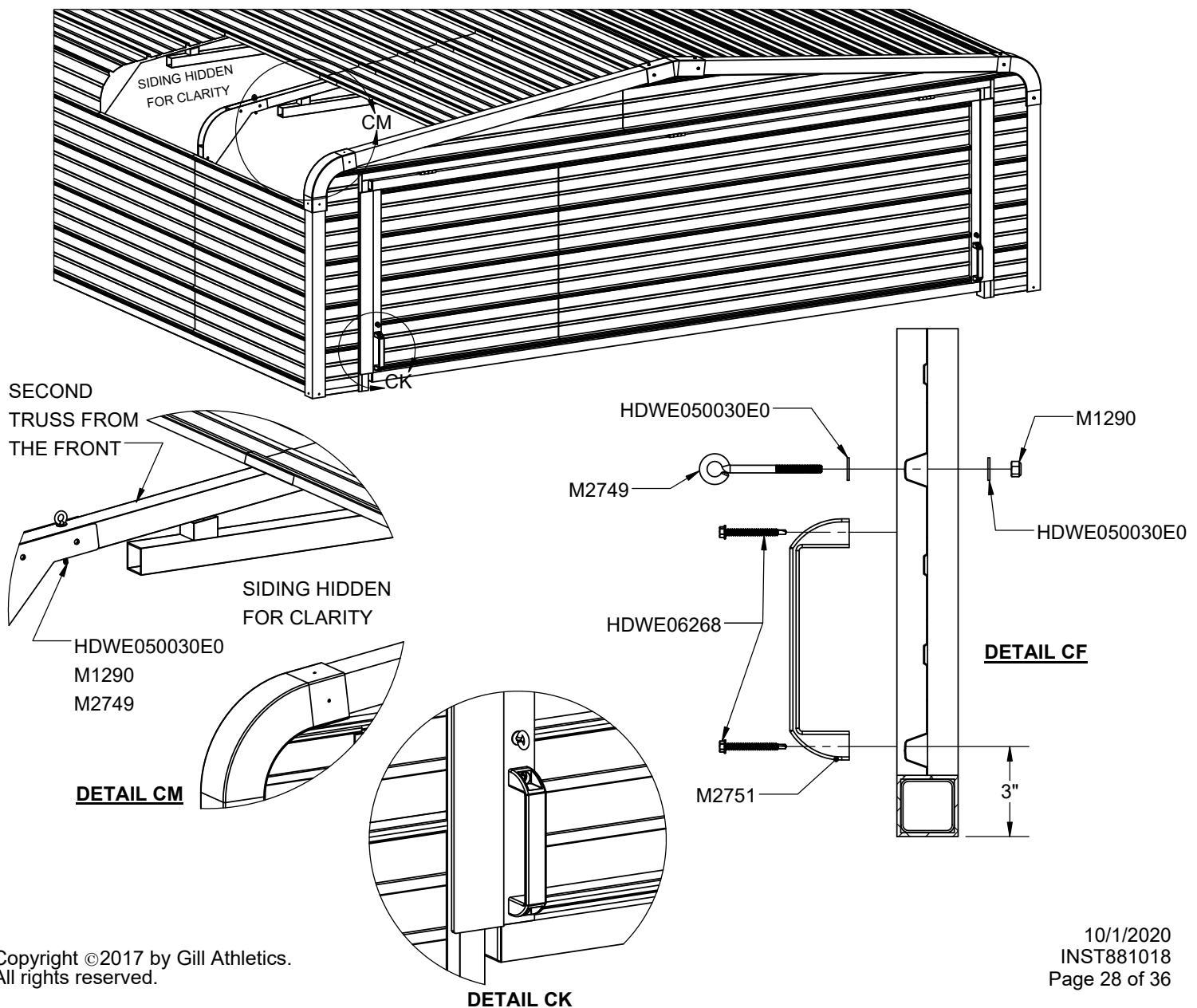

41. INSTALL ONE HASP AT EACH BOTTOM CORNER (FOR SINGLE DOORS).
WHEN INSTALLING A DOUBLE DOOR GARAGE, ATTACH ONE HASP ON THE BOTTOM OUTSIDE CORNERS OF EACH DOOR.

NOTE: THE ROTATING EYE PART SHOULD BE MOUNTED TO THE GARAGE FRAME
THE HASP ARM SHOULD BE ATTACHED TO THE DOORS (SEE **DETAIL DJ** & **DETAIL DM**).

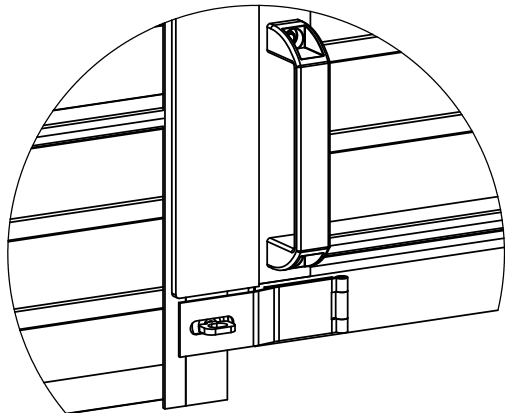
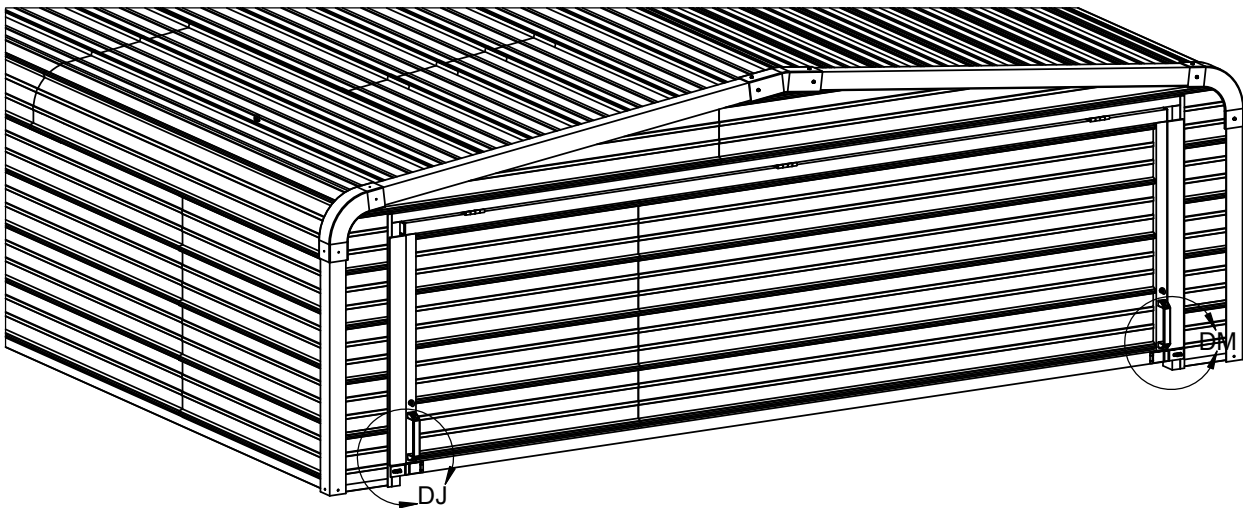

DETAIL DJ

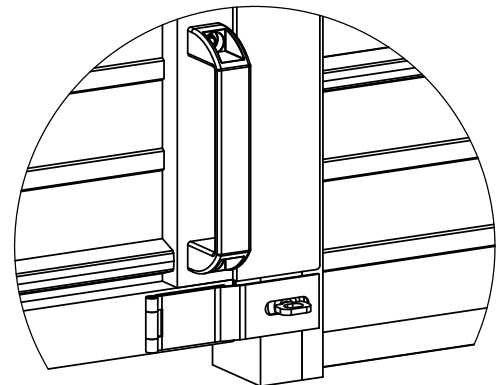

DETAIL DM

AT LEAST TWO PEOPLE ARE REQUIRED WHEN INSTALLING THE WHEEL KITS.

WHEEL KITS COME FULLY ASSEMBLED. TURN JACK CRANK ALMOST TO ITS SHORTEST POSITION BEFORE INSTALLATION.

42. LOCATE THE CENTER OF THE UPRIGHT FRAME YOU ARE MOUNTING THE WHEEL KIT TO.
 REFER TO WHEEL KIT LOCATION CHART ON NEXT PAGE.
43. **CRANK JACK ABOUT FOUR FULL TURNS DOWN BEFORE MARKING HOLE LOCATIONS.** WITH THE WHEELS NOW SLIGHTLY EXTENDED, HOLD THE ASSEMBLED WHEEL AGAINST THE SIDING WITH THE MOUNTING PLATE PARALLEL TO THE SIDING FACE.
44. MARK THE MOUNTING PLATE HOLES ONTO THE SIDING, REMOVE WHEEL KIT AND DRILL 9/16" HOLE.
45. INSTALL WHEEL KITS AS SHOWN BELOW.

NOTE: DRIVE ONE 1" SELF DRILLING SCREW (HDWE06267) INTO EACH CLAMPING PLATE TO PREVENT WHEEL KIT FROM SLIPPING. REFER TO WHEEL KIT LOCATION CHART FOR WHEEL KIT LOCATIONS.

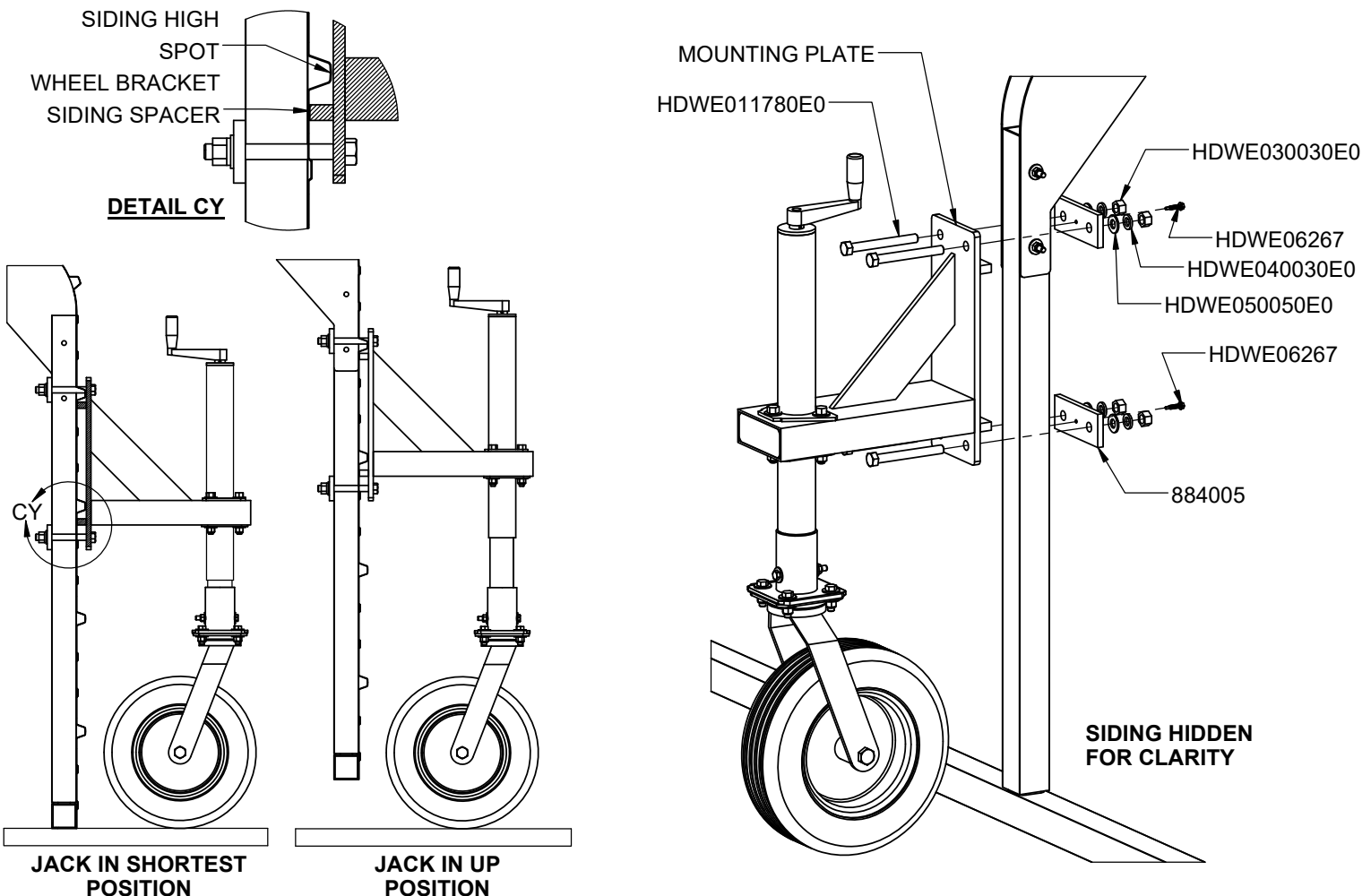

WHEEL KIT LOCATION CHART

881018
FOUR (4) WHEEL KITS

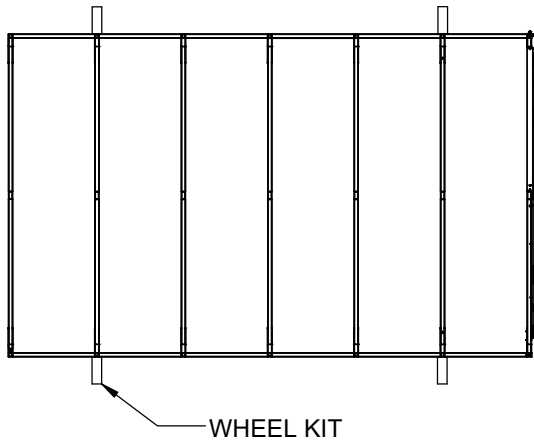

881425
EIGHT (8) WHEEL KITS

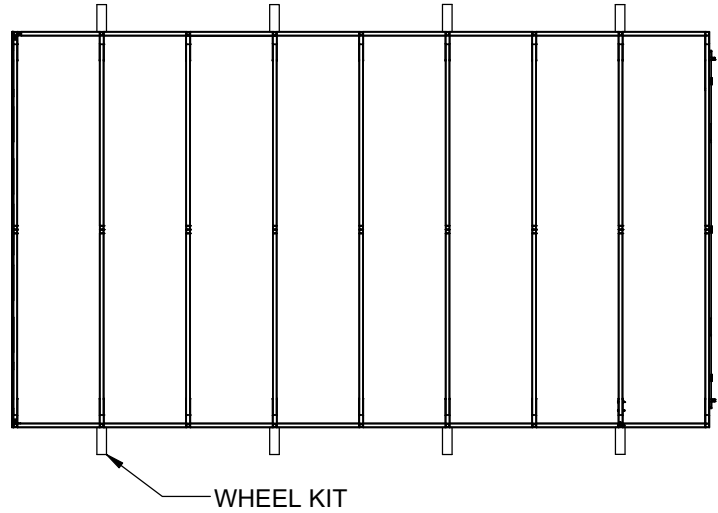

882120
SIX (6) WHEEL KITS

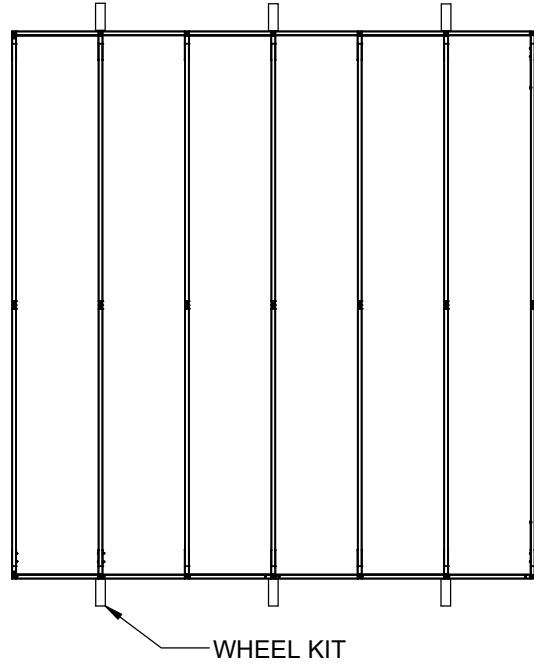

883022
EIGHT (8) WHEEL KITS

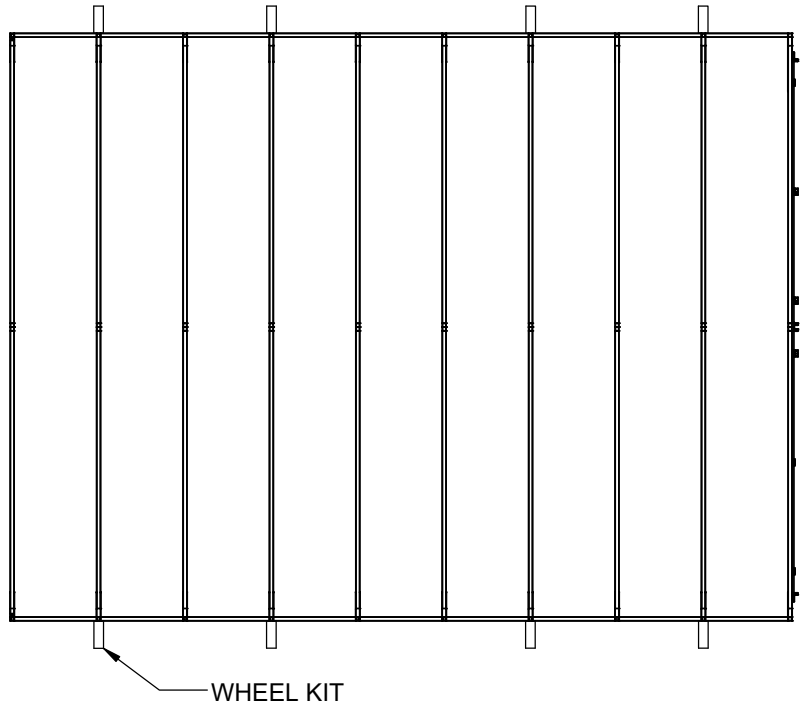

45. PLACE GILL STICKERS CENTERED ON FRONT AND REAR TRIM ANGLES AS SHOWN BELOW

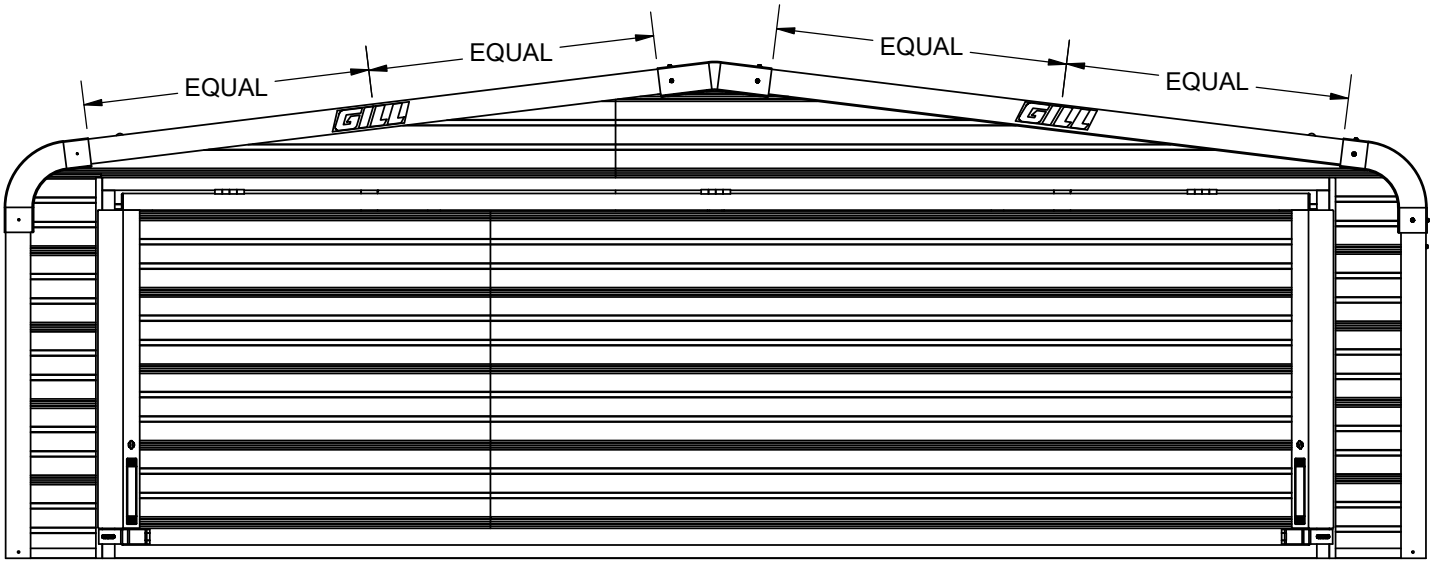

PACK LIST FOR:

881018 - PIT GARAGE; 10'x18' PITS OR SMALLER

1x FRONT TRUSS (8810186C04)

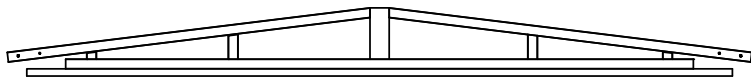

6x 8810185

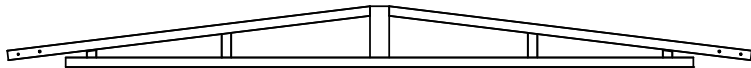

1x DOOR (8810183C04)

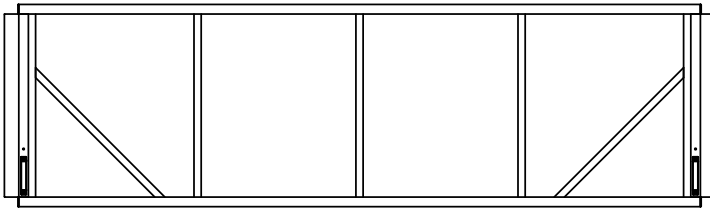

1x HORIZONTAL REAR SPREADER (8810188)



4x BOTTOM SPLICE WELDMENT (88432)



4x SHORT ANGLE TRIM (88440C04)



4x LONG ANGLE TRIM (88441C04)

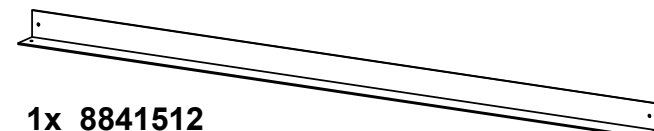

1x 8841512

BOX CONTAINS 12x FLAT BRACES

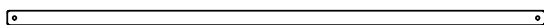

1x 884010 - GABLE AND CORNER PIECES

1x 8810189 - HARDWARE KIT

1x RIGHT CORNER FRAME (88407C04)

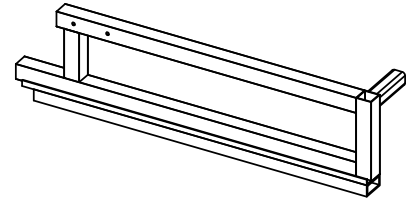

1x LEFT CORNER FRAME (88408C04)

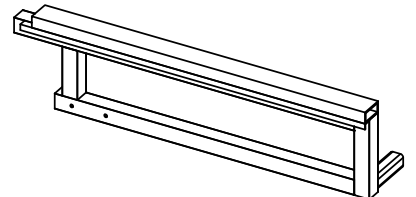

36x SIDING (88410)

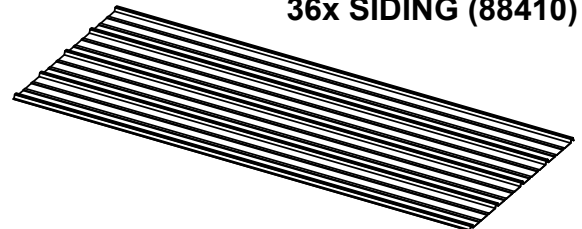

3x VERTICAL SPREADERS (88417)



2x DIAGONAL BRACES (88416)



12x DRILLED UPRIGHTS (88424)



1x 8841428

BOX CONTAINS 28 (GUSSET)

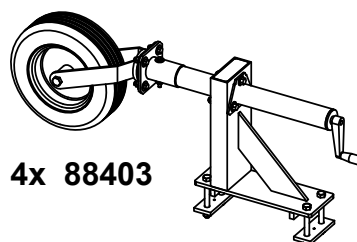
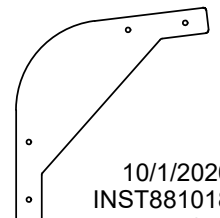

4x 88403

PACK LIST FOR:

881425 - PIT GARAGE; 14'x25' PITS OR SMALLER

**1x FRONT TRUSS
(8814256LC04)**

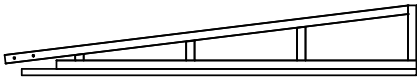

16x 8814255



1x DOOR (8814253C04)

**1x FRONT TRUSS
(8814256RC04)**

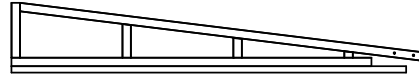

2x BOTTOM SPLICE WELDMENT (88434)

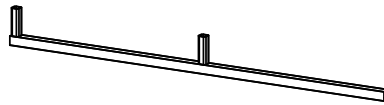

1x RIGHT CORNER FRAME (88407C04)

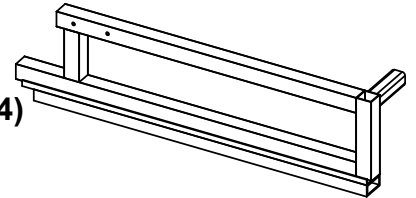

1x LEFT CORNER FRAME (88408C04)

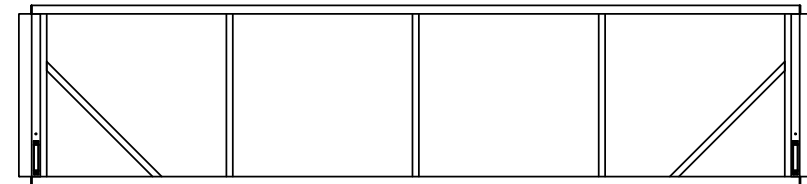
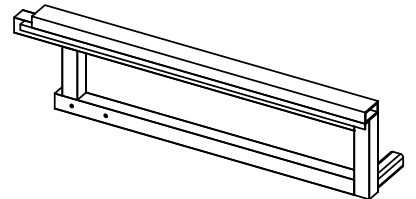

1x HORIZONTAL REAR SPREADER (8814258)



4x BOTTOM SPLICE WELDMENT (88432)

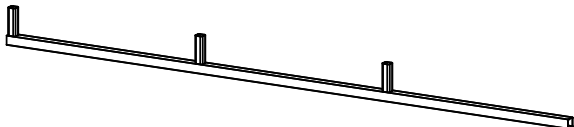

4x SHORT ANGLE TRIM (88440C04)

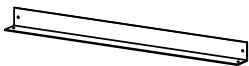

4x LONG ANGLE TRIM (88442C04)

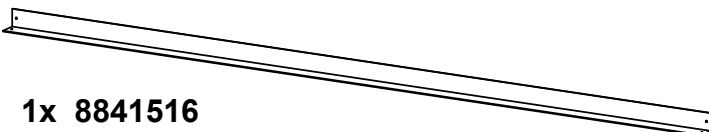

1x 8841516

BOX CONTAINS 16x FLAT BRACES

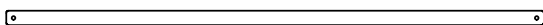

1x 884010 - GABLE AND CORNER PIECES

1x 8814259 - HARDWARE KIT

40x SIDING (88410)

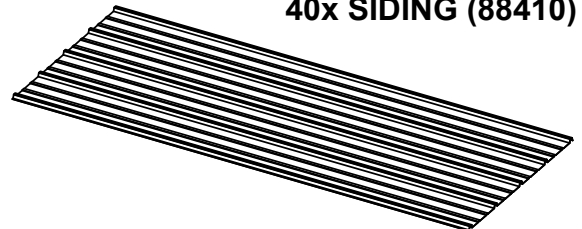

4x VERTICAL SPREADERS (88417)



2x DIAGONAL BRASES (88416)



16x DRILLED UPRIGHTS (88424)



2x 8841418

EACH BOX CONTAINS 18 (GUSSET)

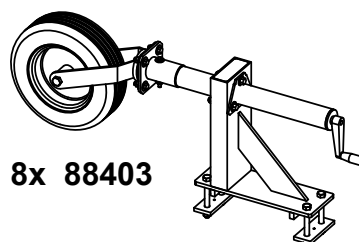

8x 88403

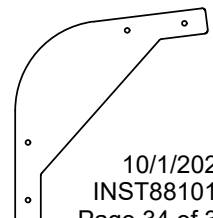

PACK LIST FOR:

882120 - PIT GARAGE; 21'x20' PITS OR SMALLER

**1x FRONT TRUSS
 (8821206LC04)**

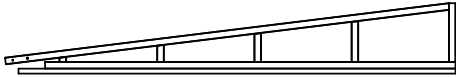

**1x FRONT TRUSS
 (8821206RC04)**

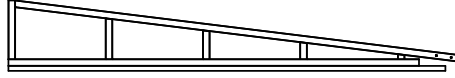

1x RIGHT CORNER FRAME (88407C04)

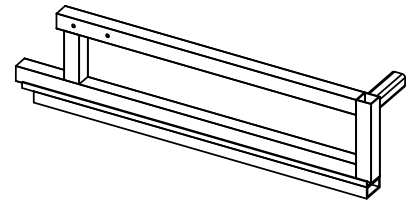

12x STANDARD TRUSS (8821205)



2x DOOR (8821203C04)

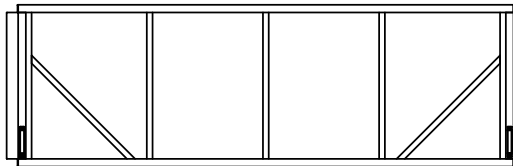

1x LEFT CORNER FRAME (88408C04)

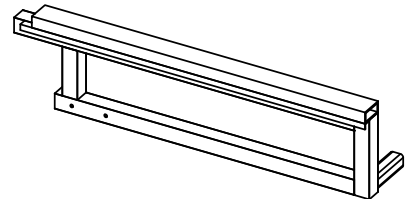

2x HORIZONTAL REAR SPREADER (8821208)



48x SIDING (88410)

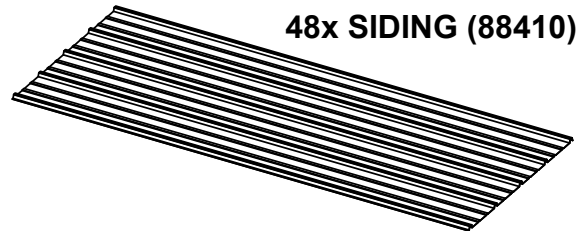

4x BOTTOM SPLICE WELDMENT (88432)

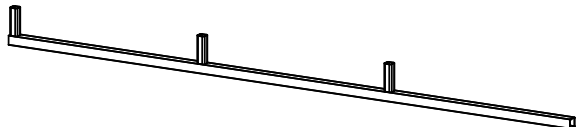

6x VERTICAL SPREADERS (88417)

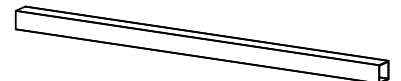

4x SHORT ANGLE TRIM (88440C04)

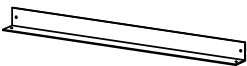

2x DIAGONAL BRASES (88416)

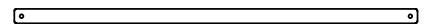

4x LONG ANGLE TRIM (88443C04)

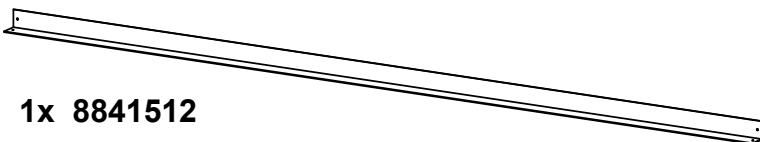

12x DRILLED UPRIGHTS (88424)



1x 8841512

BOX CONTAINS 12x FLAT BRACES

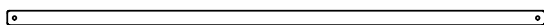

2x 8841414

EACH BOX CONTAINS 14 (GUSSET)

1x 884010 - GABLE AND CORNER PIECES

1x 8821209 - HARDWARE KIT

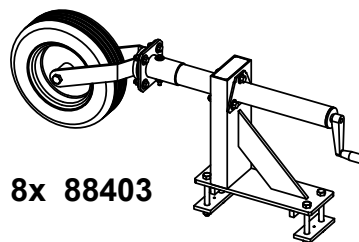

8x 88403

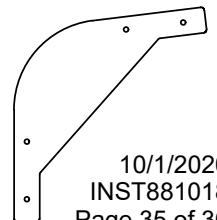

PACK LIST FOR:

883022 - PIT GARAGE; 30'x22' PITS OR SMALLER

**1x FRONT TRUSS
(8830226LC04)**

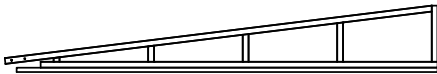

**1x FRONT TRUSS
(8830226RC04)**

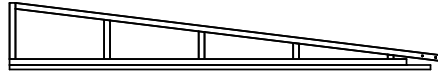

18x STANDARD TRUSS (8830225)

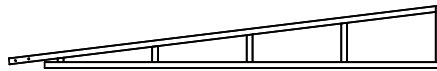

2x DOOR (8830223C04)

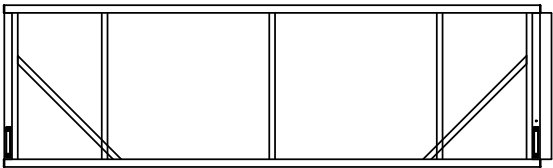

2x HORIZONTAL REAR SPREADER (8830228)



6x BOTTOM SPLICE WELDMENT (88432)



4x SHORT ANGLE TRIM (88440C04)



4x LONG ANGLE TRIM (88444C04)

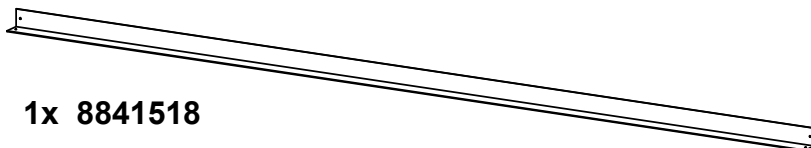

1x 8841518

BOX CONTAINS 18x FLAT BRACES

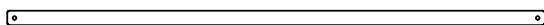

1x 884010 - GABLE AND CORNER PIECES

1x 8821209 - HARDWARE KIT

1x RIGHT CORNER FRAME (88407C04)

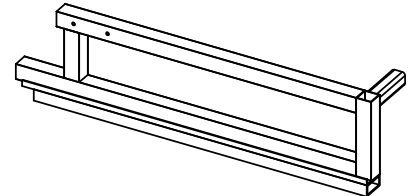

1x LEFT CORNER FRAME (88408C04)

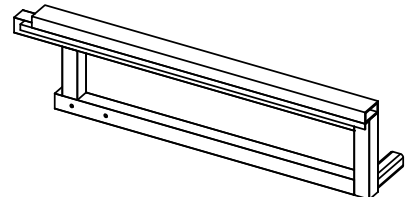

65x SIDING (88410)

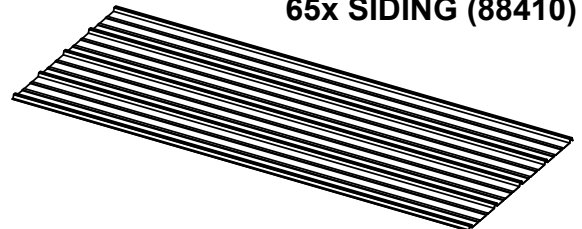

6x VERTICAL SPREADERS (88417)



2x DIAGONAL BRASES (88416)

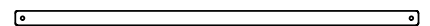

18x DRILLED UPRIGHTS (88424)

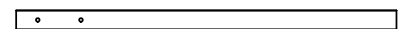

2x 8841420

EACH BOX CONTAINS 20 (GUSSET)

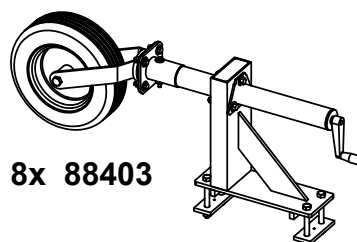

8x 88403

